

EVÖK™ COLLECTION



eRTA® Cabinet

EVÖK YOUR SENSES: EXPERIENCE THE BEAUTY
AND QUALITY OF OUR CABINETRY.

SPECIFICATION BOOK – PRE-RELEASE

TABLE OF CONTENT

- ABOUT MAKELLOS4
- EVÖK COLLECTION6
 - LEGACY SERIES DOOR STYLE8
 - ESSENCE SERIES DOOR STYLE9
 - DAWN SERIES DOOR STYLE.....10
 - DRAWERS SPECIFICATIONS..... 11
 - eRTA® CABINET 12
 - eRTA® WALL CABINETS SPECIFICATIONS..... 14
 - eRTA® BASE CABINETS SPECIFICATIONS 15
 - CABINETS OVERVIEW 16
 - SIDE PANELS FINISH STYLES18
 - DESIGN RECOMMENDATIONS 19
 - FINISHED WALL INTEGRATED PANELS COMPATIBILITY20
 - FINISHED BASE INTEGRATED PANELS COMPATIBILITY 21
- MODIFICATIONS22

TABLE OF CONTENT

SPECIFICATION	23
WALL CABINETS	23
REFRIGERATOR WALL CABINETS	25
SPECIALTY WALL CABINETS	26
CORNER WALL CABINETS	28
WALL END CABINETS	29
WINE CABINETS	30
BASE CABINETS	31
SINK BASE CABINETS	32
CORNER BASE CABINETS	33
END BASE CABINETS	35
SPECIALTY BASE CABINETS	36
TALL CABINETS	38
OVEN CABINETS	39
VANITY CABINETS	40
DESK CABINETS	41
ACCESSORIES	42
GLASS DOORS	42
WALL ACCESSORIES	43
BASE ACCESSORIES	43
VALANCE	43
FILLERS	44
FINISHED END PANELS	45
DECORATION DOORS	47
MOLDINGS	48
RANGE HOOD	50
POST	51
UPGRADES	52
PRODUCT CARE	53
SAMPLES	54
LIMITED WARRANTY	56
TERMS AND CONDITIONS	58

ABOUT MAKELLOS

Introducing Makellos Cabinetry, the family-owned business that has revolutionized the kitchen cabinet industry with their pursuit of perfection. Founded over a decade ago by a father and son team, Makellos Cabinetry was born out of a desire to provide quality kitchen cabinets that were not only functional, but beautiful as well.

Tired of the subpar imported products distributed locally, the founders of Makellos Cabinetry set out to create their own line of cabinets that would meet their high standards of craftsmanship. With over 40 years of experience as a master carpenter, the father had a keen eye for detail and a deep understanding of what makes a great cabinet. Together with his son, they developed the EVÖK Collection, a series of kitchen cabinets that are not only beautiful but easy to assemble with their evolutionary RTA cabinetry system.

At the heart of Makellos Cabinetry is a commitment to quality and innovation. The eRTA® Cabinet is designed with the latest Threespine® click furniture technology, a revolutionary system that allows for simplified assembly. The result is a cabinet that can be put together in less than a minute, saving time and money on installation.

Makellos Cabinetry takes pride in using only the finest materials, ensuring that each cabinet is not only beautiful but also durable and functional. Their cabinets are made with high-quality wood that is chosen for its durability and flexibility. The team at Makellos Cabinetry understands that the perfect cabinet is not just about the materials but also the design. That's why they offer a variety of styles and finishes, allowing homeowners to create a kitchen that truly reflects their unique style.

From humble beginnings in a retail design center, Makellos Cabinetry has grown to become a leader in the kitchen cabinet industry. With their commitment to quality, innovation, and customer satisfaction, it's no wonder that they have become the go-to choice for homeowners and contractors alike. Choose Makellos Cabinetry and experience the difference that quality and innovation can make in your kitchen.







EVÖK™

COLLECTION



EVÖK COLLECTION

EVÖK YOUR SENSES: EXPERIENCE THE BEAUTY AND QUALITY OF OUR CABINETRY.

The EVÖK Collection by Makellos Cabinetry is an innovative line of kitchen products that combines sleek modern design with cutting-edge functionality.

This collection is designed to meet the evolving needs of modern homeowners who demand both style and substance in their kitchen spaces.

Named after the phrase "Evolutionary Kitchen", the EVÖK Collection represents the culmination of decades of research and development into kitchen design, featuring state-of-the-art materials and advanced features that make cooking and entertaining easier and more enjoyable than ever before.

With its emphasis on innovation and quality, the EVÖK Collection is the perfect choice for homeowners who want to create a kitchen that is both beautiful and functional, providing a space for cooking, entertaining, and creating lasting memories with family and friends.

DOOR STYLE

LEGACY SERIES

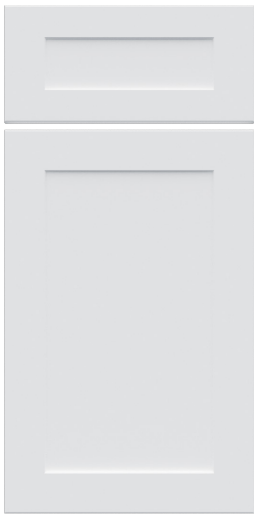
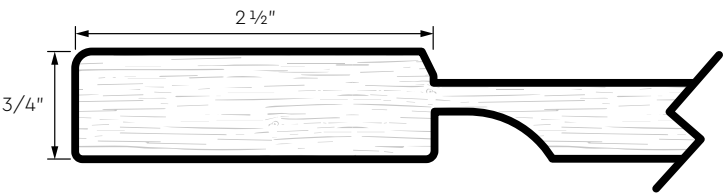

LEGACY
ARCTIC
L1

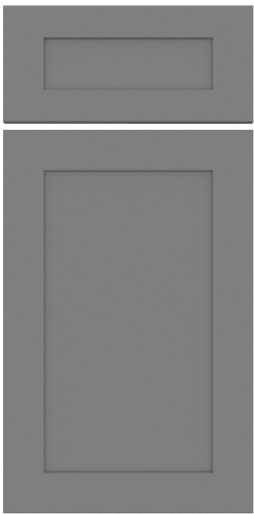

LEGACY
NIMBUS
L2

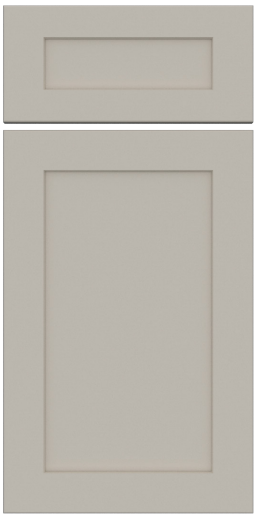

LEGACY
SAND
L3

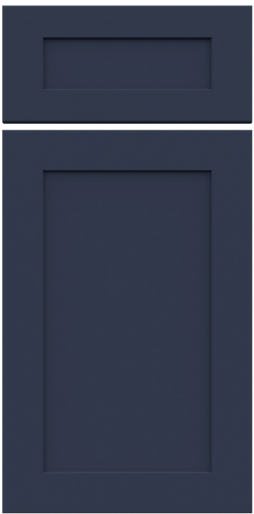

LEGACY
SEA
L4

CONSTRUCTION	5-piece solid wood. Mortise and tenon construction
CENTER PANEL	Engineered wood reverse raised composite
STYLE	Full overlay door

DOOR STYLE

ESSENCE SERIES

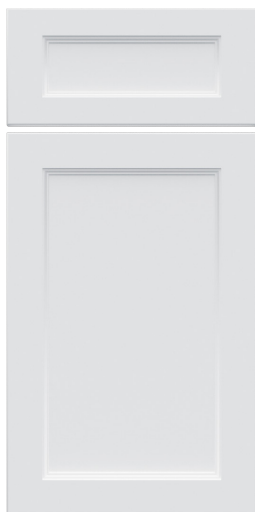
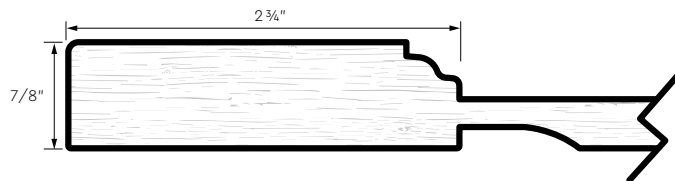

ESSENCE
ARCTIC
E1



ESSENCE
EVERGREEN
E5

CONSTRUCTION	5-piece solid wood. Mortise and tenon construction
CENTER PANEL	Engineered wood reverse raised composite
STYLE	Full overlay door

DOOR STYLE

DAWN SERIES

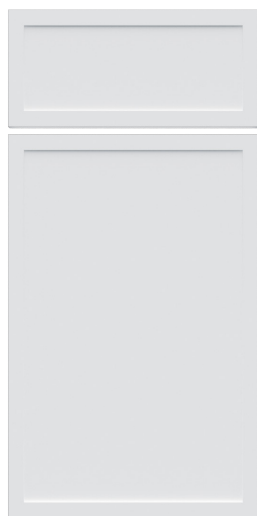
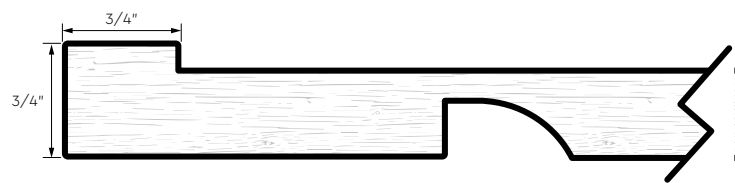

DAWN
ARCTIC
D1

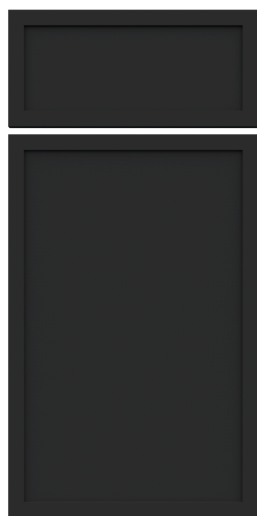

DAWN
ECLIPSE
D6

CONSTRUCTION	5-piece MDF door. Mitered joint construction
CENTER PANEL	Engineered wood reverse raised composite
STYLE	Full overlay door

DRAWERS SPECIFICATIONS



FEATURES	Adjustable soft close concealed full extension drawer glides, quiet and smooth system
CONSTRUCTION	5/8" Solid wood drawer box, dovetailed construction
FINISH COLOR	Natural finish
DRAWER BOTTOM	3/8" Plywood
DRAWER ATTACHMENT	Micro Adjustable figure 8, drawer alignment attachment

eRTA[®] Cabinet

Experience the eRTA[®] difference:
Innovative and hassle-free evolutionary
RTA Cabinet.

TECHNOLOGY

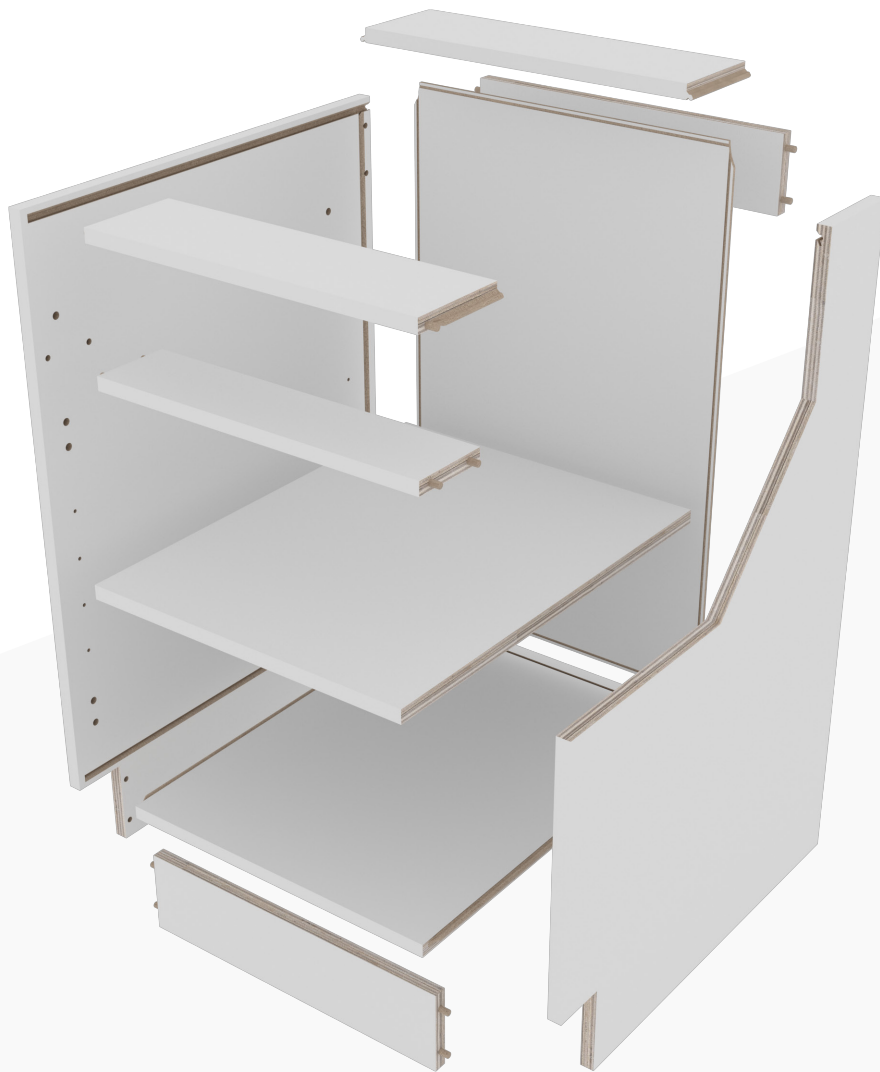

Assembled with:



Utilizing the industry's state of the art,
Threespine® click furniture technology by
Välinge Innovation, cabinetry assembly is
now 5 to 10 times faster.

eRTA® WALL CABINET SPECIFICATIONS



ASSEMBLY	Featuring state of the art Threespine® click furniture technology.
SIDE PANELS	3/4" Select Plywood edge-banded in white
BACK PANEL	5mm Select Plywood back panel
OVERALL DEPT	13" deep
SHELVES	Adjustable 3/4" Plywood edge-banded in White
HINGES	Concealed 6-Way Adjustable Soft-Close Hinge

eRTA® BASE CABINET SPECIFICATIONS



ASSEMBLY	Featuring state of the art Threespine® click furniture technology.
SIDE PANELS	3/4" Select Plywood edge-banded in white
BACK PANEL	5mm Select Plywood back panel
SHELVES	Full depth 3/4" adjustable Plywood edge-banded in White
HINGES	Concealed 6-Way Adjustable Soft-Close Hinge

eRTA® CABINETS OVERVIEW

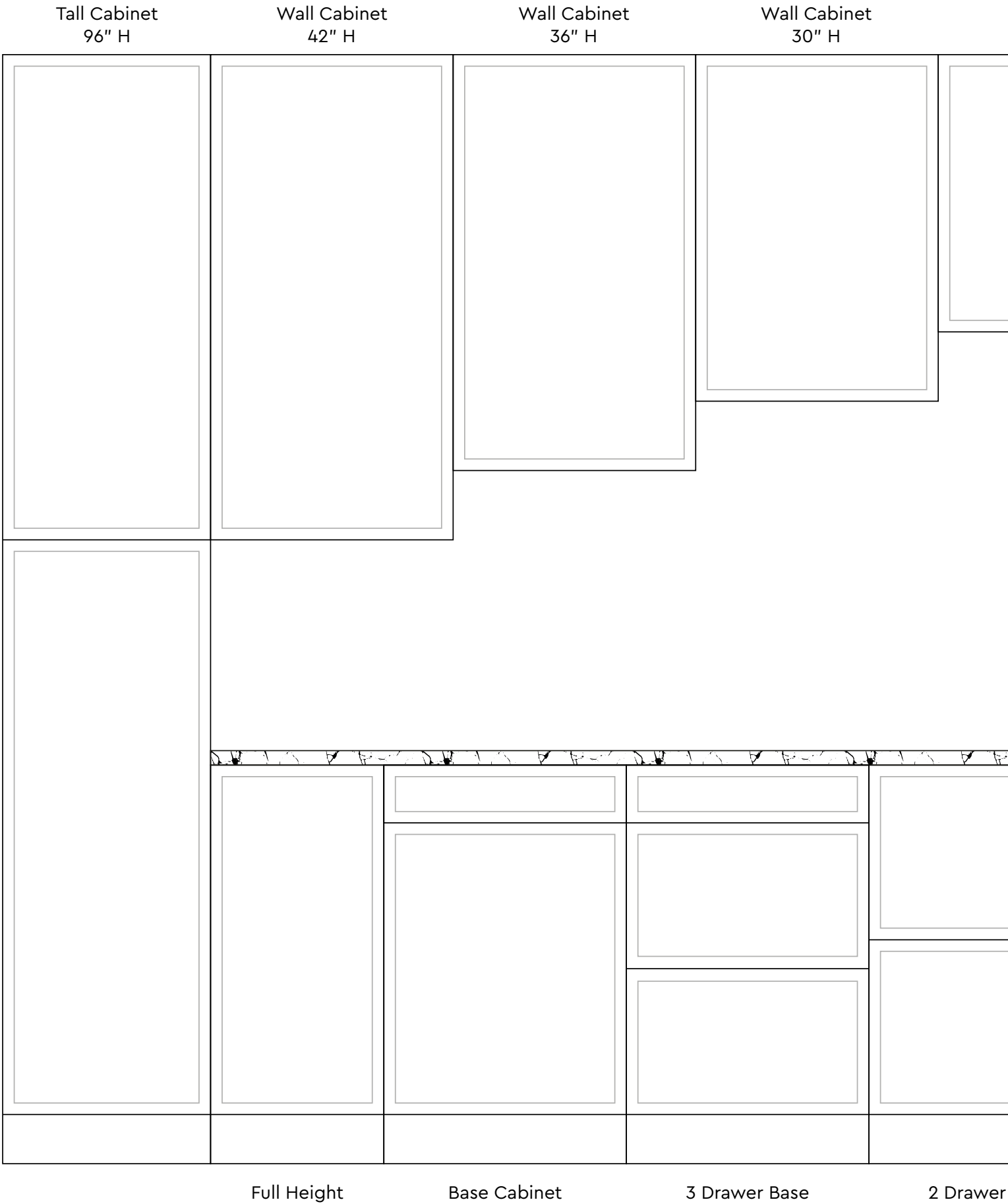

Wall Cabinet
24" H

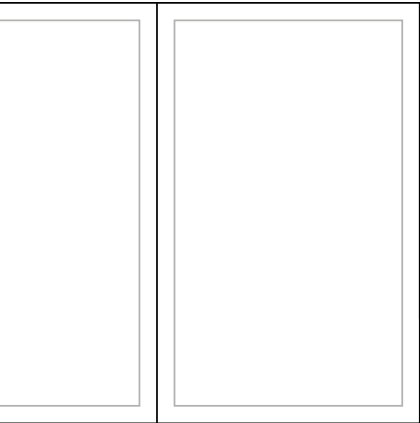

Wall Cabinet
18" H

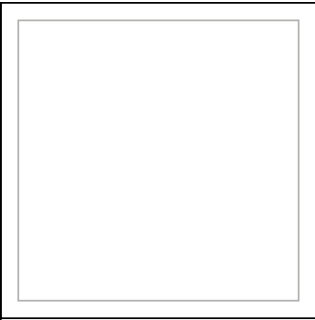

Wall Cabinet
15" H

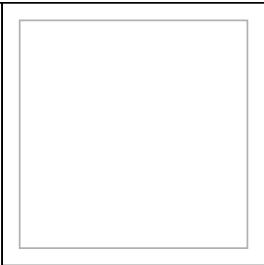

Wall Cabinet
12" H

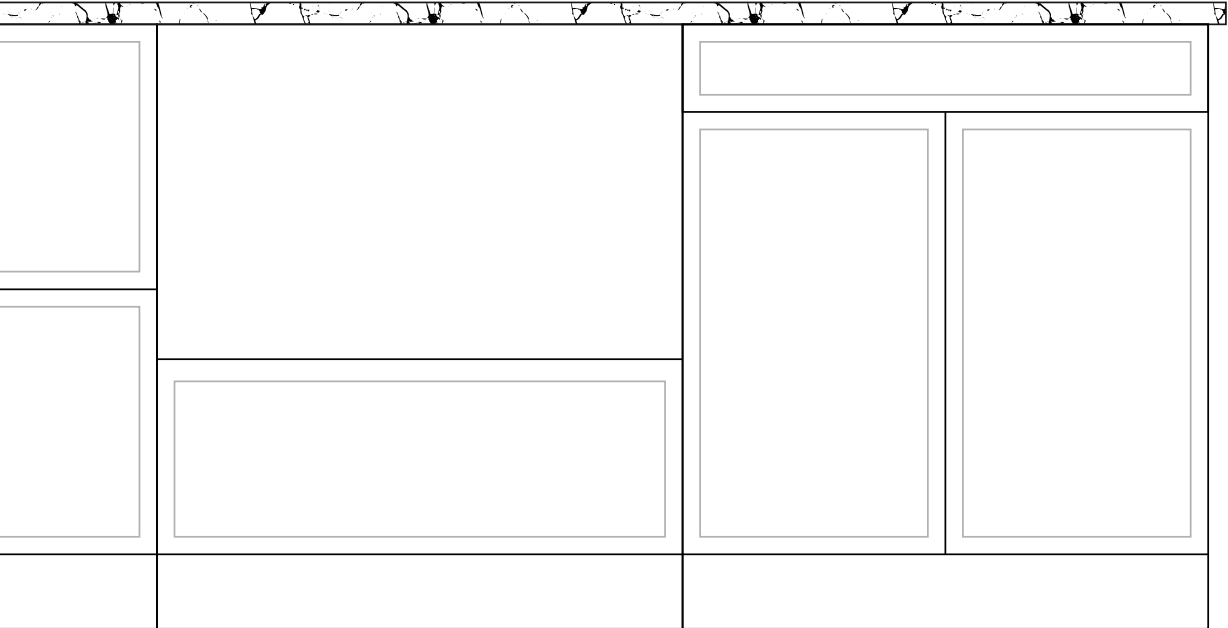
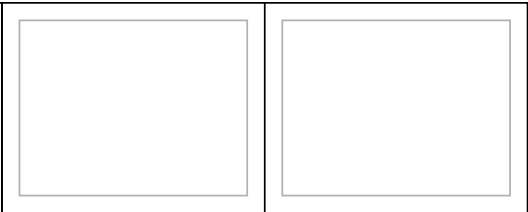

Base

Microwave Base

Sink Base

SIDE PANELS FINISH STYLES

A

– Fastest and Easiest finishing method. Simply add 3/4" Wall or Base end panel.

Wall Items: WEP1430, WEP1436 and WEP1442

Base Items: BEP25

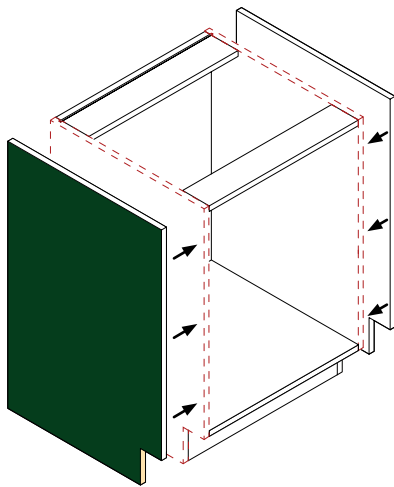
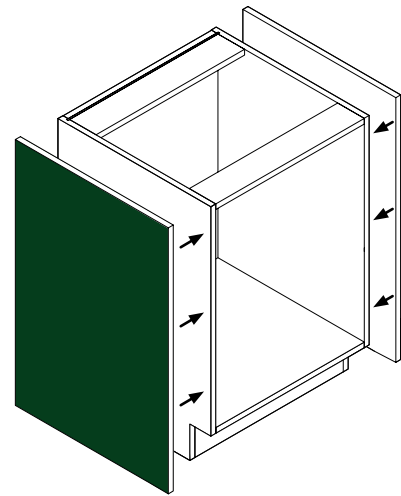

B

– Replace the existing white melamine plywood sides with Wall or Base Integrated panels.

Wall Items: WIP1330, WIP1336 and WIP1342

Base Items: BIP-L and or BIP-R

For items not listed; custom carcass can be made. Please note this will extend lead times. Contact us for availability.

DESIGN INSIGHTS

Our **eRTA**® cabinet boxes feature a universal White box color in and out. When designing, a matching 3/4" panel is required anytime there is an exposed end.

Remember to also use a panel next to appliances or when varying cabinet heights are used.

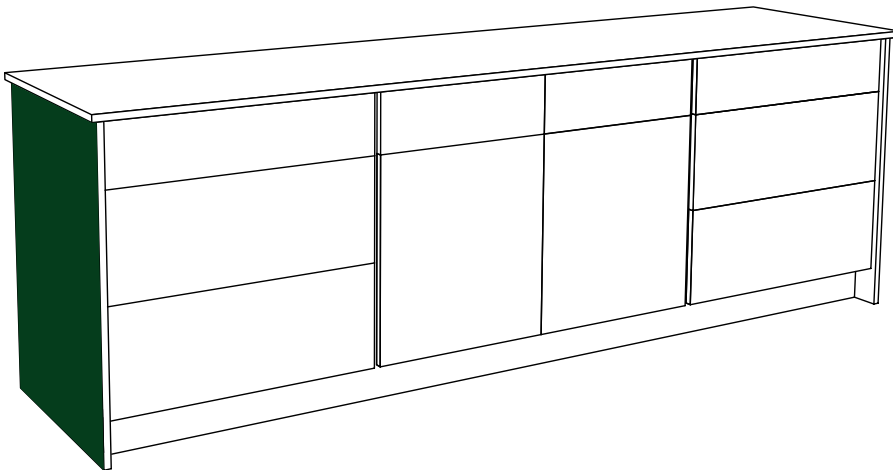
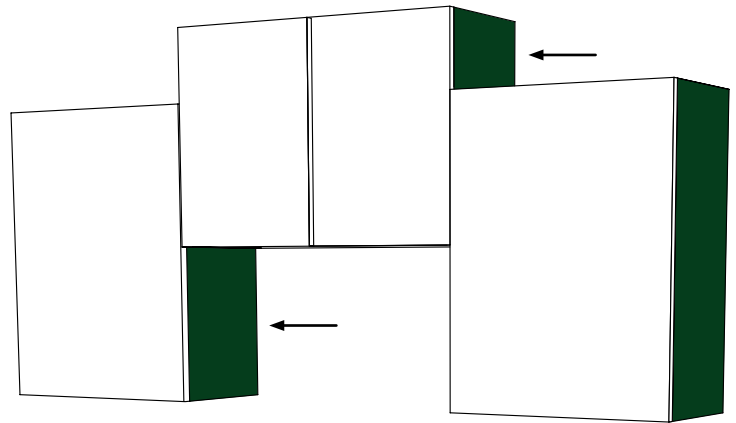

eRTA® end panels are oversized and designed to be trimmed down to be flushed flush with the door front, giving an inset appearance.

eRTA® base end panels can either be installed with a notched 4-1/2" H toe kick, or without the notched toekick cut out.

- A. Integrated Panel – Notched Toekick panel**
- B. End Panel – No Notched Toekick panel**
(NOTCHED TOEKICK AVAILABLE AS A UPGRADE)

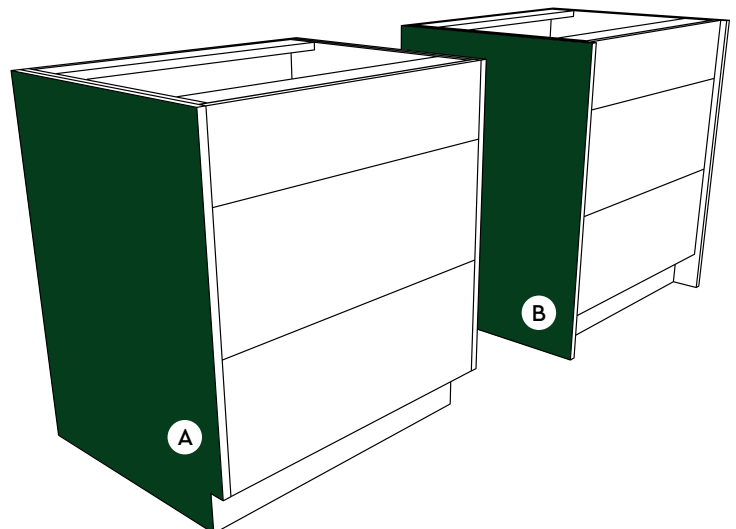

FINISHED WALL INTEGRATED PANELS COMPATIBILITY

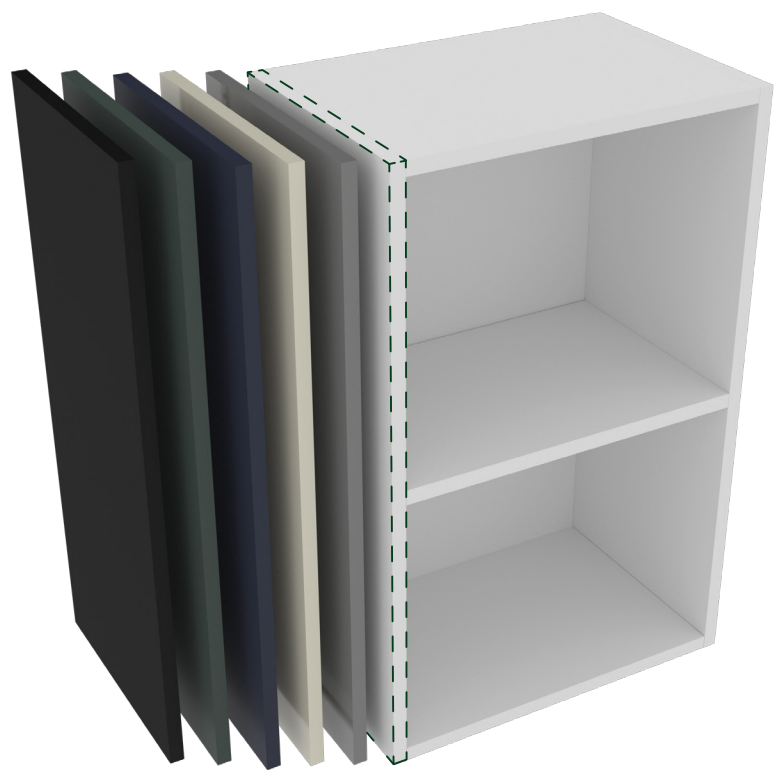

Our **eRTA**® wall cabinet boxes feature a universal White box in and out. When designing, a matching 3/4" panel is required anytime there is an exposed end.

WIP1330		WIP1336		WIP1342
W0930	WBU3030	W0936	WBU3036	W0942
W1230	WBU3630	W1236	WBU3636	W1242
W1530		W1536		W1542
W1830		W1836		W1842
W2130		W2136		W2142
W2430		W2436		W2442
W2730		W2736		W2742
W3030		W3036		W3042
W3330		W3336		W3342
W3630		W3636		W3642

WIP NOT REQUIRED FOR ARCTIC COLORS

FINISHED BASE INTEGRATED PANELS COMPATIBILITY

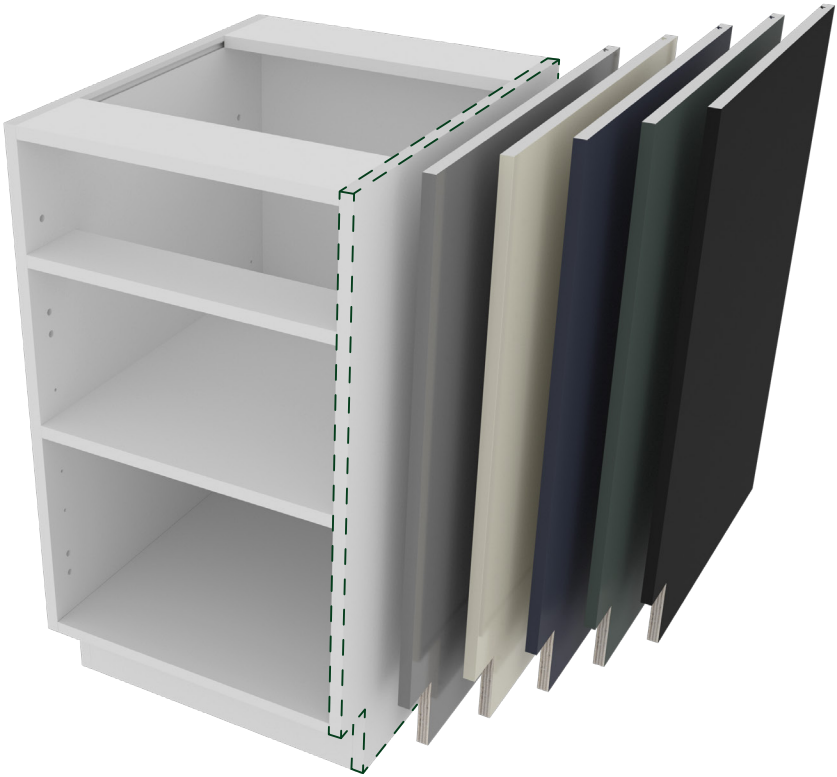

Our **eRTA®** base cabinet boxes feature a universal White box in and out. When designing, a matching 3/4" panel is required anytime there is an exposed end.









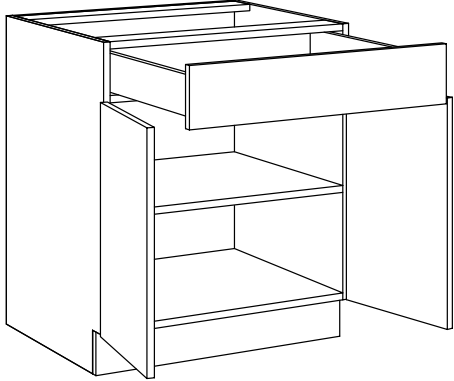

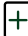









BIPL			BIPR		
B09FH	B12	2DB30	B09FH	B12	2DB30
B12FH	B15	2DB36	B12FH	B15	2DB36
B15FH	B18	3DB12	B15FH	B18	3DB12
B18FH	B21	3DB15	B18FH	B21	3DB15
B21FH	B24	3DB18	B21FH	B24	3DB18
B24FH	B27	3DB21	B24FH	B27	3DB21
B27FH	B30	3DB24	B27FH	B30	3DB24
B30FH	B33	3DB30	B30FH	B33	3DB30
B33FH	B36	3DB36	B33FH	B36	3DB36
B36FH	2DB24		B36FH	2DB24	

BIP NOT REQUIRED FOR ARCTIC COLORS

MODIFICATIONS

A. EXAMPLE



Item #	Mods
BXX	   
BXX	   
BXX	   
BXX	   
BXX	   



SIDE PANEL

Replace Wall, Base or Tall Cabinet White Box side with Integrated Panel (Each Side)



ADD ROT

Install pull out roll out tray in cabinet (ROT not incl.) (specify height from bottom)

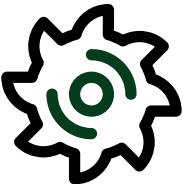

CUT DEPTH

- Reduce Depth of Base cabinet (min. depth 15.5" for drawer)
- Reduce Depth of Wall cabinet (min. 4") (Each Time)
- Reduce Depth of Tall cabinet (Each)

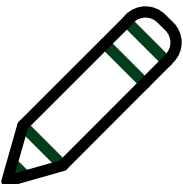

CUSTOM

Any CUSTOMIZATIONS without changing the size of Wall, Base or Tall cabinet.

Plans are Required.

WALL CABINETS

A. 30" High single door wall cabinet

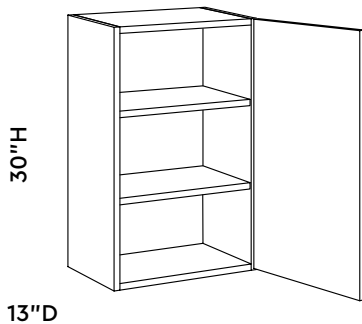

Item #	Mods
W0930	
W1230	
W1530	
W1830	
W2130	

1 Door, 2 Adjustable shelves, **WIP** Compatible
Specify L/R Hinge at the time of order

B. 30" High double door wall cabinet

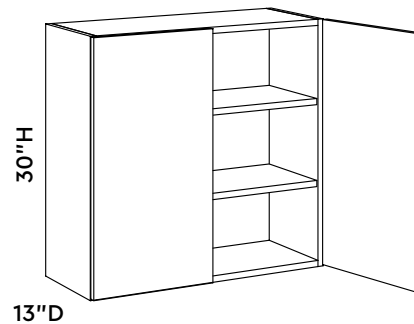

Item #	Mods
W2430	
W2730	
W3030	
W3330	
W3630	

2 Door, 2 Adjustable shelves, **WIP** Compatible

C. 36" High single door wall cabinet

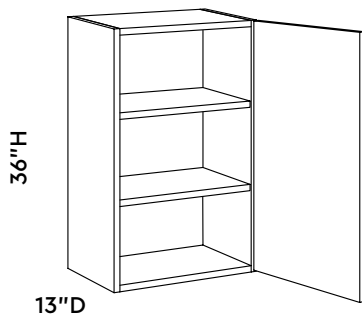

Item #	Mods
W0936	
W1236	
W1536	
W1836	
W2136	

1 Door, 2 Adjustable shelves, **WIP** Compatible
Specify L/R Hinge at the time of order

D. 36" High double door wall cabinet

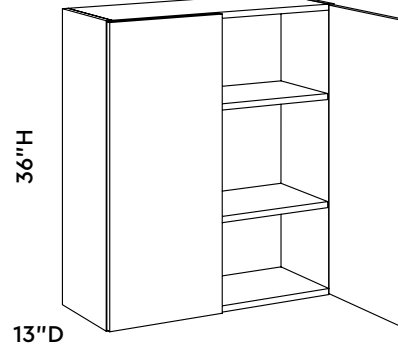

Item #	Mods
W2436	
W2736	
W3036	
W3336	
W3636	

2 Door, 2 Adjustable shelves, **WIP** Compatible

E. 42" High single door wall cabinet

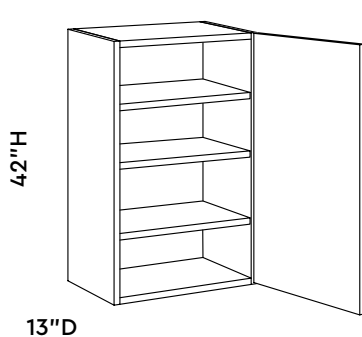

Item #	Mods
W0942	
W1242	
W1542	
W1842	
W2142	

1 Door, 3 Adjustable shelves, **WIP** Compatible
Specify L/R Hinge at the time of order

F. 42" High double door wall cabinet

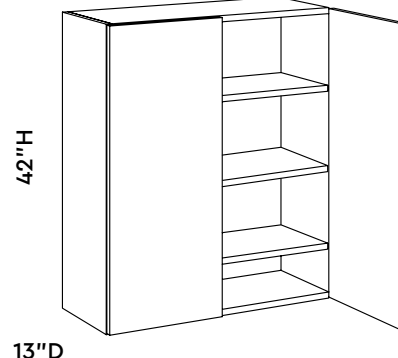

Item #	Mods
W2442	
W2742	
W3042	
W3342	
W3642	

2 Door, 3 Adjustable shelves, **WIP** Compatible

WALL CABINETS

G. 15" High single door wall cabinet



15" H

13" D

Item #	Mods
W1515	  

1 Door, No Shelf

H. 18" High single door wall cabinet



18" H

13" D

Item #	Mods
W1818	  





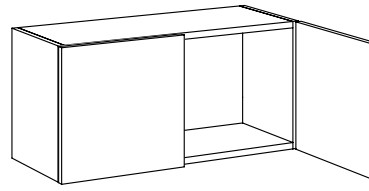

1 Door, No Shelf

I. 12" High double door wall cabinet

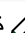

12" H

13" D

Item #	Mods
W3012	  
W3312	  
W3612	  





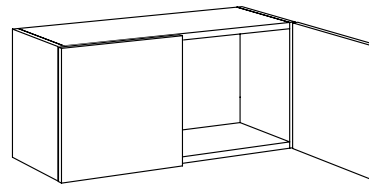





2 Door, No Shelf

J. 15" High double door wall cabinet

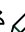

15" H

13" D

Item #	Mods
W2415	  
W3015	  
W3315	  
W3615	  





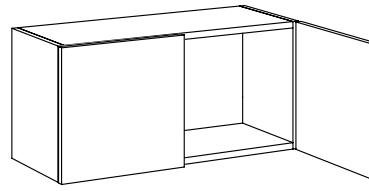







2 Door, No Shelf

K. 18" High double door wall cabinet



18" H

13" D

Item #	Mods
W2418	  
W3018	  
W3318	  
W3618	  

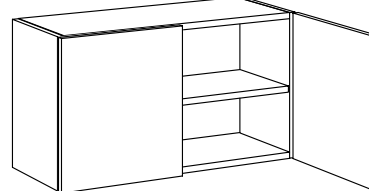

2 Door, No Shelf

L. 24" High double door wall cabinet



24" H

13" D

Item #	Mods
W2424	  
W3024	  
W3324	  
W3624	  

2 Door, 1 Shelf

REFRIGERATOR WALL CABINETS

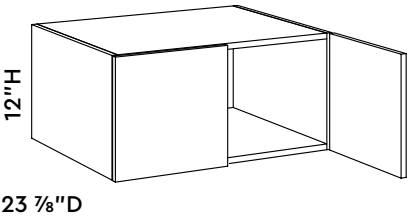

A. 12" High double refrigerator wall cabinet



12"H

23 7/8"D

2 Door

Item #	Mods
W361224	  



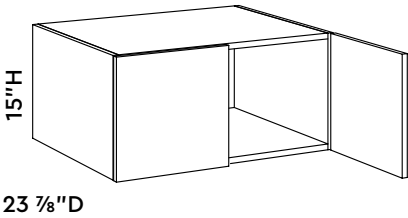





B. 15" High double refrigerator wall cabinet



15"H

23 7/8"D

2 Door

Item #	Mods
W301524	  
W331524	  
W361524	  



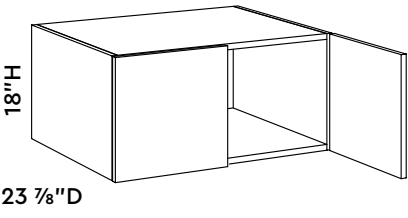





C. 18" High double refrigerator wall cabinet



18"H

23 7/8"D

2 Door

Item #	Mods
W301824	  
W331824	  
W361824	  



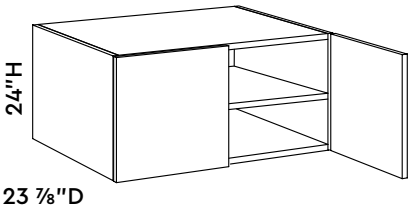





D. 24" High double refrigerator wall cabinet



24"H

23 7/8"D

2 Door, 1 Shelf

Item #	Mods
W302424	  
W332424	  
W362424	  

SPECIALTY WALL CABINETS

A. 15" & 18" Lift up wall cabinet

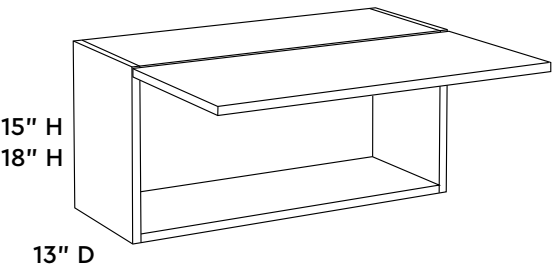

Item #	Mods
WLU3015	
WLU3615	
WLU3018	
WLU3618	

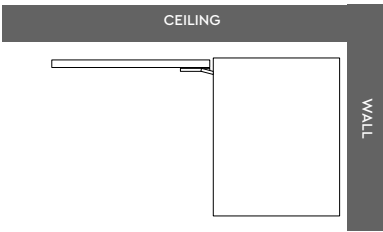

SIDE VIEW

1 Door, No Shelf,
Clearance for handles/knobs above cabinet is required

B. 30" & 36" High bifold up double door wall cabinet

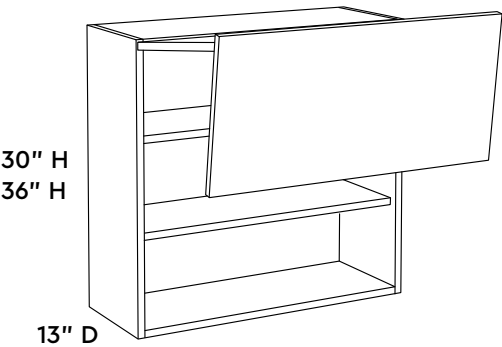

Item #	Mods
WBU3030	
WBU3630	
WBU3036	
WBU3636	

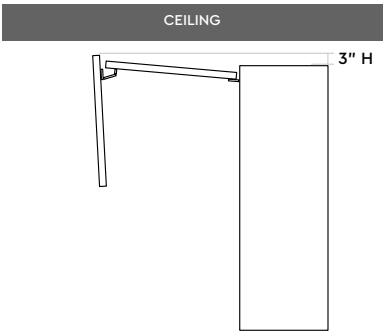

SIDE VIEW

1 Door, 2 adjustable shelves, Shelves not full depth, **WIP** Compatible,
3" Clearance required above cabinet

C. 48", 54" & 60" Wall drawer cabinet

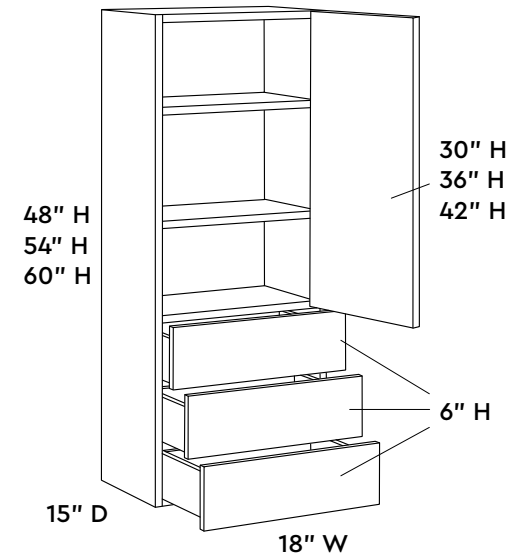

Item #	Mods
WD1848	
WD1854	
WD1860	

1 Door, 2 adjustable shelves, 3 drawers
3 Adjustable shelves available for 60" H only

SPECIALTY WALL CABINETS

D. Microwave shelf

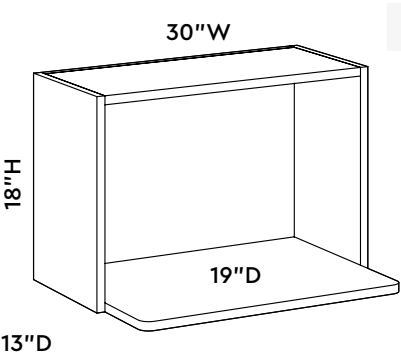

Item #	Mods
MWS301813	  

Painted matching door finish

E. Wall Organizer

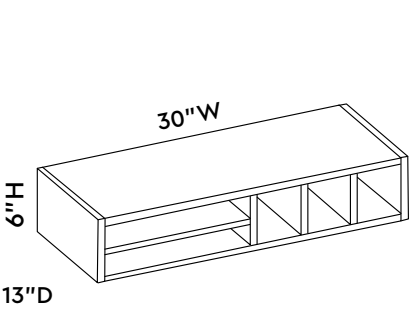

Item #	Mods
WO3006	  

Painted matching door finish

F. Wall Organizer

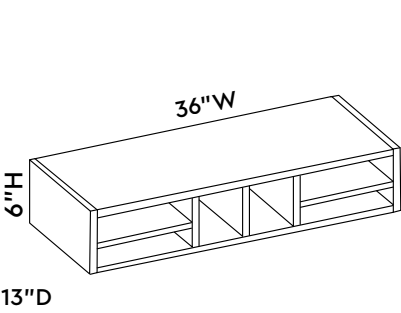

Item #	Mods
WO3606	  

Painted matching door finish

CORNER WALL CABINETS

A. 30", 36" & 42" High blind wall cabinet

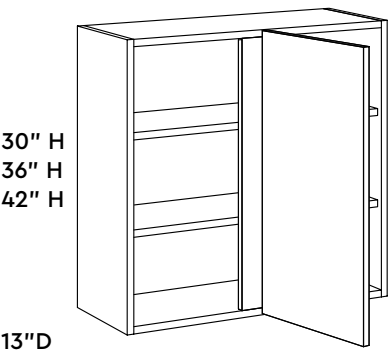

1 Door, 2 Adjustable shelves,
3 Adjustable shelves available for 42" H only
Must use filler on adjacent side
Specify L/R Blind at the time of order

Designer recommendations:
Add overlay filler to flush with door

Item #	Mods
BW2430	
BW2436	
BW2442	

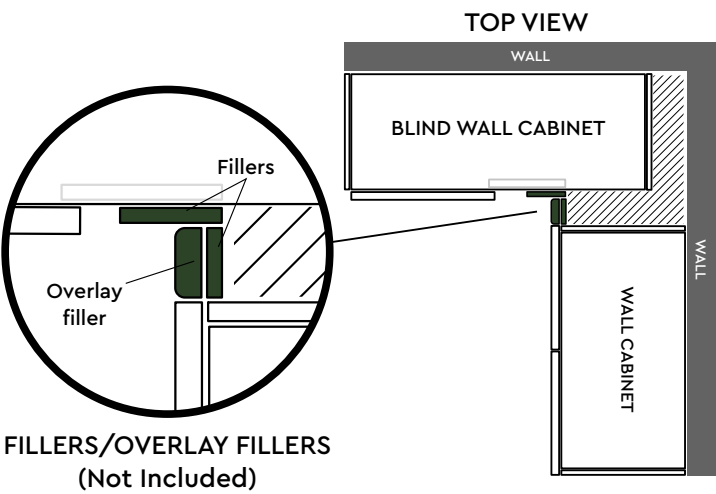

Actual Cabinet	Door Opening	Mid-Stile	Door Size	Min/Max Pull
25"	10 3/4"	6"	10 7/8"	25" / 28"

B. Diagonal corner wall cabinet

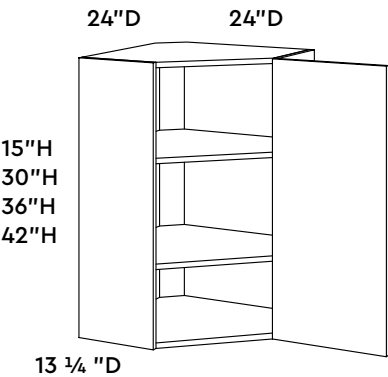

1 Door, 2 Adjustable shelves
*No Adjustable shelves for 15"
3 Adjustable shelves available for 42" H only
Specify L/R Hinge at the time of order

Item #	Mods
CW2415*	
CW2430	
CW2436	
CW2442	

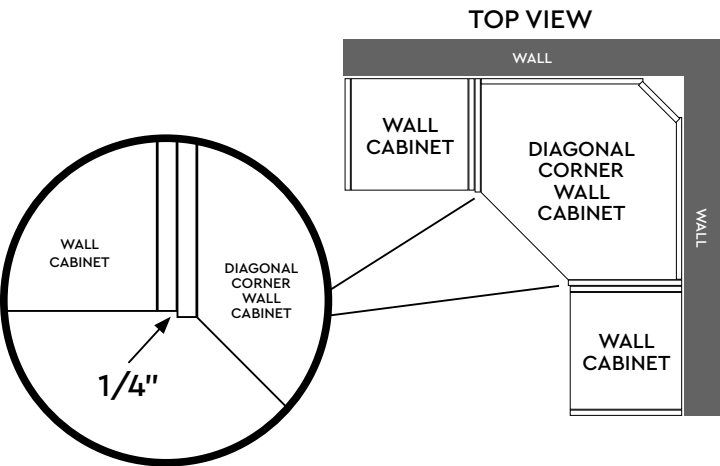

Note: Side Panels of this cabinet are 1/4" deeper than other standard wall cabinets.
Side panels extend beyond the adjacent boxes for proper operation of the doors.

CORNER WALL CABINETS

C. Square corner wall cabinet

24"D

24"D

15"H

30"H

36"H

42"H

13"D

Item #

Mods

WER2415*

WER2430

WER2436

WER2442

1 Door, 2 Adjustable shelves

No soft close

*No Adjustable shelf for 15"

3 Adjustable shelves available for 42" H only

Specify L/R Hinge at the time of order

WALL END CABINETS

A. Wall end shelf

9"W

13"D

30"H

36"H

42"H

WES-L

WES-R

Item #

Mods

WES0930

WES0936

WES0942

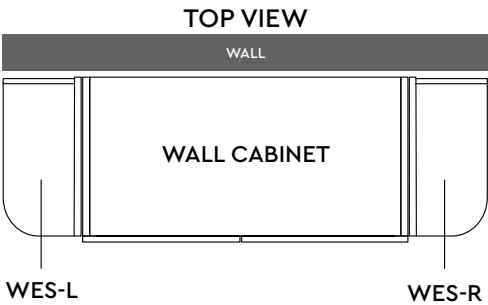

3 fixed shelves, 4 fixed shelves available for 42" H only

Specify L/R at the time of order

Painted matching door finish

WINE CABINETS

A. Wine rack cabinet

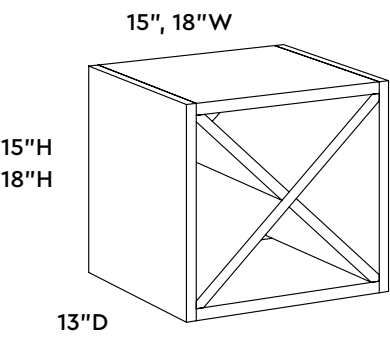

Item #	Mods
WRX15	
WRX18	

Painted matching door finish

B. Wine rack cabinet

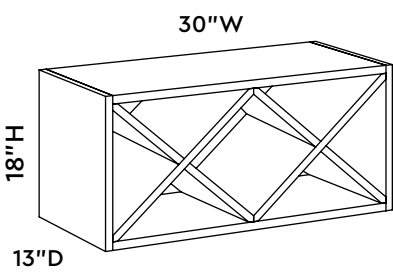

Item #	Mods
WRX3018	

Painted matching door finish

C. Wine Cabinet

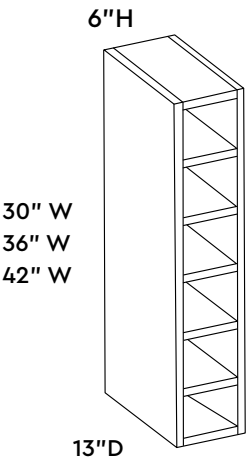

Item #	Mods
WC0630	
WC0636	
WC0642	

Painted matching door finish

BASE CABINETS

A. Full height single door base cabinet

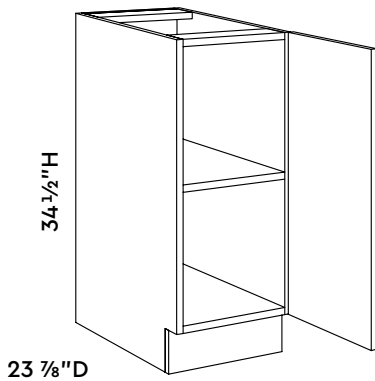

Item #	Mods
B09FH	
B12FH	
B15FH	
B18FH	
B21FH	

1 Door, 1 Adjustable shelf, **BIP** Compatible,
Specify L/R Hinge at the time of order,

B. Full height two door base cabinet

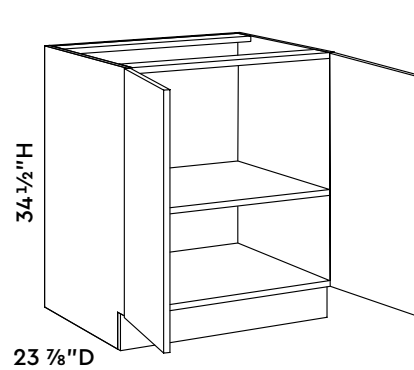

Item #	Mods
B24FH	
B27FH	
B30FH	
B33FH	
B36FH	

1 Door, 1 Adjustable shelf, **BIP** Compatible,

C. Single drawer and door base cabinet

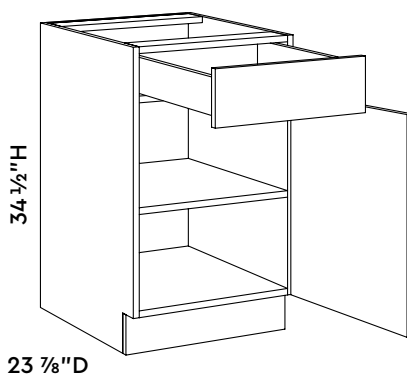

Item #	Mods
B12	
B15	
B18	
B21	

1 Drawer, 1 Door, 1 Adjustable shelf, **BIP** Compatible,
Specify L/R Hinge at the time of order,

D. Single drawer and two door base cabinet

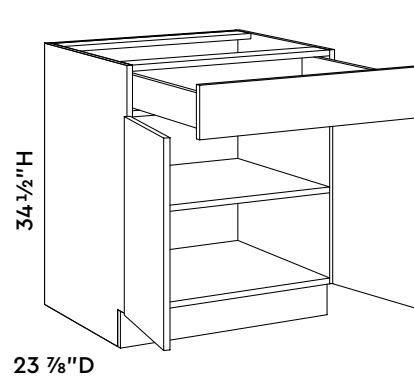

Item #	Mods
B24	
B27	
B30	
B33	
B36	

1 Drawer, 2 Doors, 1 Adjustable shelf 1 Door
BIP Compatible,

E. Two drawer base cabinet

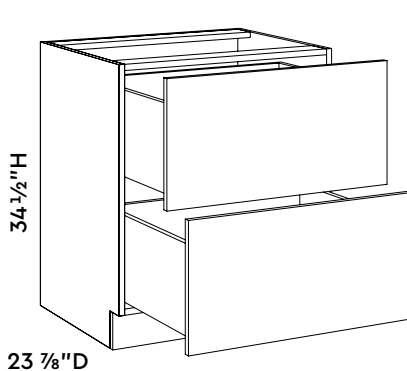

Item #	Mods
2DB24	
2DB30	
2DB36	

2 Drawers, **BIP** Compatible

F. Three drawer base cabinet

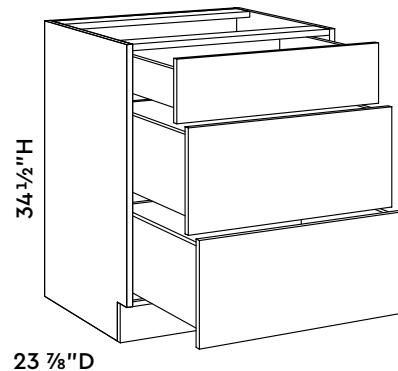

Item #	Mods
3DB12	
3DB15	
3DB18	
3DB21	
3DB24	
3DB30	
3DB36	

3 Drawers, **BIP** Compatible

SINK BASE CABINETS

A. Sink base cabinet

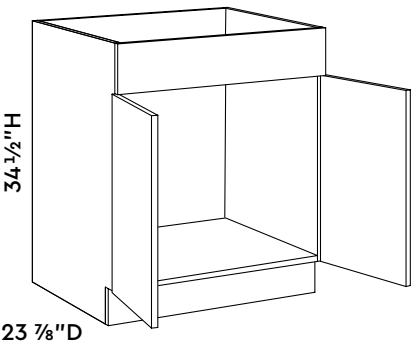

Item #	Mods
SB24	
SB27	
SB30	
SB33	
SB36	
SB39	

1 False Drawer, 2 Doors, 1 Adjustable shelf

B. Farm sink base cabinet

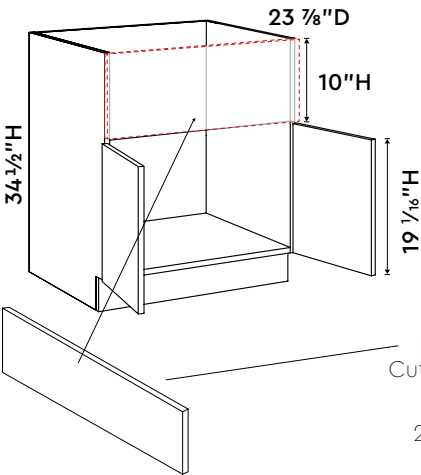

Item #	Mods
FSB30	
FSB36	

10" H
Finished Panel
Cut size as required

2 Doors

C. Diagonal corner sink base cabinet

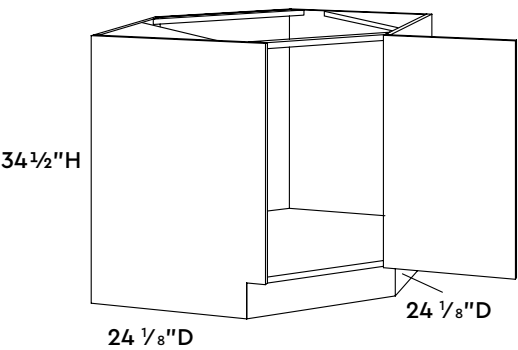

Item #	Mods
DSB36	

1 Full height door, 1 Door
Specify L/R Hinge at the time of order

***Note:** End Side Panels of this cabinet are 1/4" deeper than other standard base cabinets.
End panels must extend beyond the adjacent boxes for proper operation of the doors.

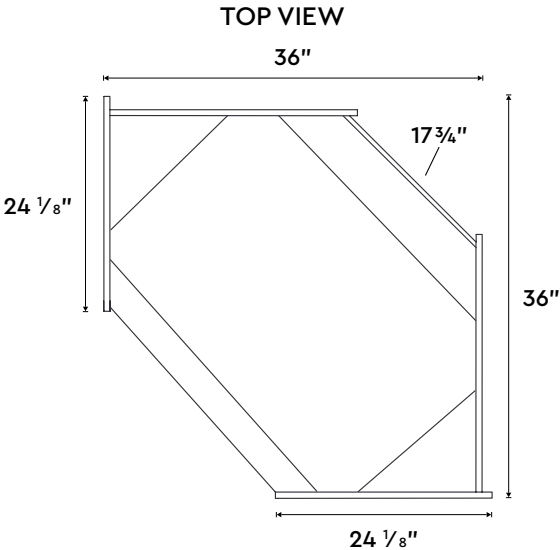

CORNER BASE CABINETS

A. Lazy susan

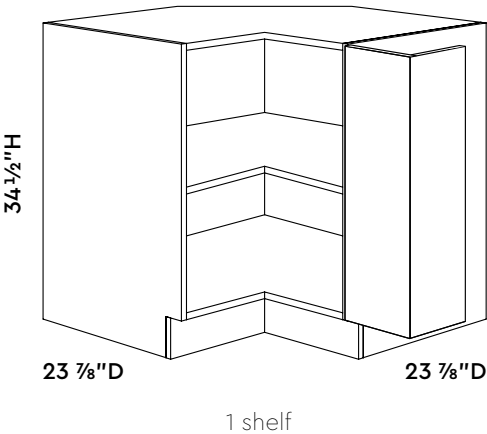

Item #	Mods
ER33	
ER36	

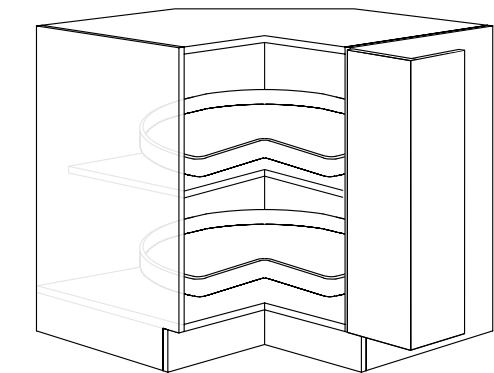
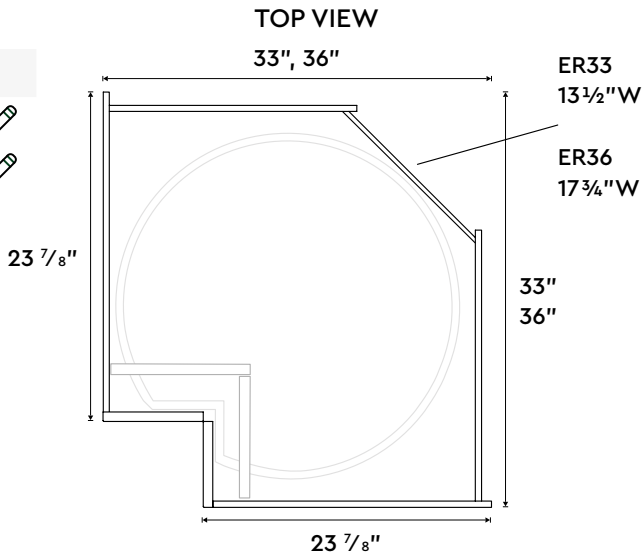

Item #	Mods
ER33NLS	
ER36NLS	

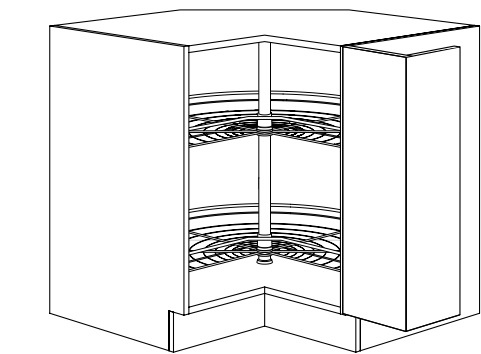
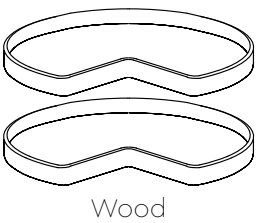

Item #	Mods
ER33MLS	
ER36MLS	

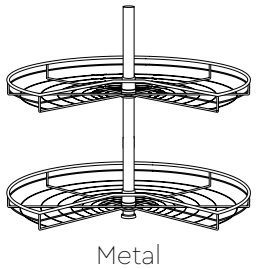

Once assembled, door cannot be reversed,
Both Lazy Susan trays rotate independently,
Soft close hinge not available
Specify L/R hinge at the time of order

CORNER BASE CABINETS

B. Blind base cabinets

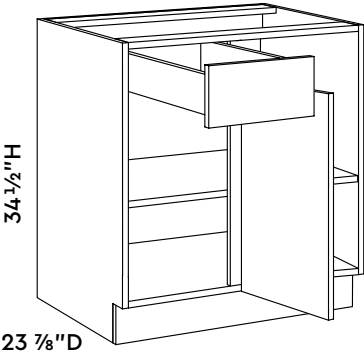

1 Drawer, 1 Door, 1 Adjustable shelf
Specify L/R Hinge at the time of order
Designer recommendations:
Add overlay filler to flush with door

Item #	Mods
BBC36	
BBC39	
BBC42	

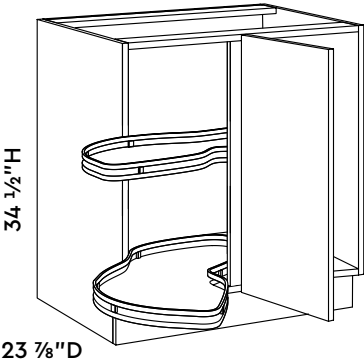
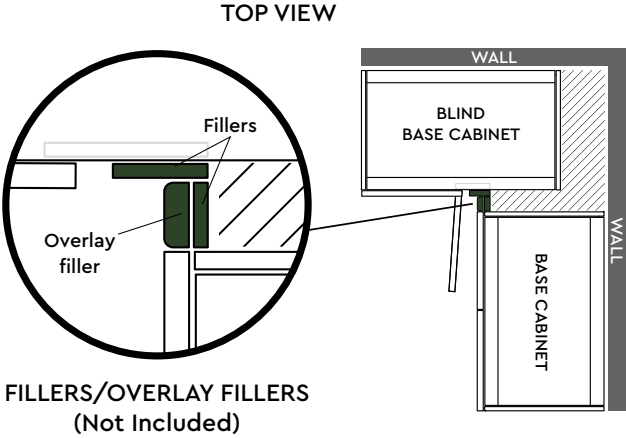

1 Door, Lemans pull-out
Specify L/R Hinge at the time of order
Designer recommendations:
Add overlay filler to flush with door

Item #	Mods
BBC45	
BBC48	

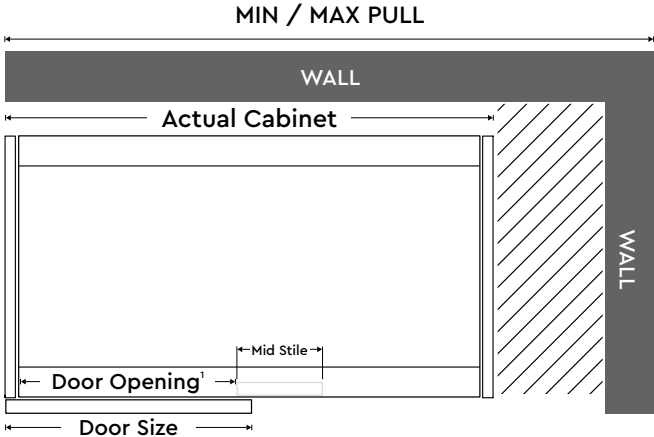

Item #	Actual Cabinet	Door Opening¹	Mid-Style	Door Size	Min/Max Pull
BBC36	30"	9 1/2"	9 5/8"	10 7/8"	36" / 42"
BBC39	33"	10 5/8"	10 3/8"	11 7/8"	39" / 45"
BBC42	36"	13 5/8"	7 3/8"	14 7/8"	42" / 48"
BBC45	42"	18"	7 1/2"	19 5/8"	45" / 51"
BBC48	42"	22"	7 1/2"	23 5/8"	45" / 51"

END BASE CABINETS

A. Base end angle cabinet

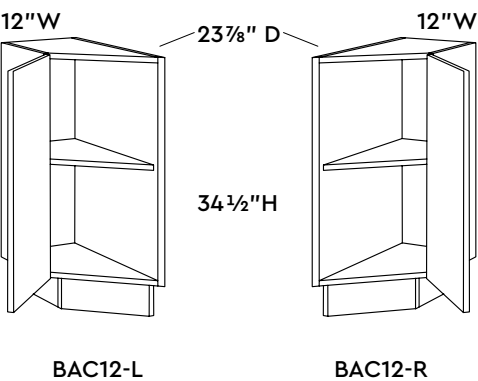

Item #	Mods
BAC12	  

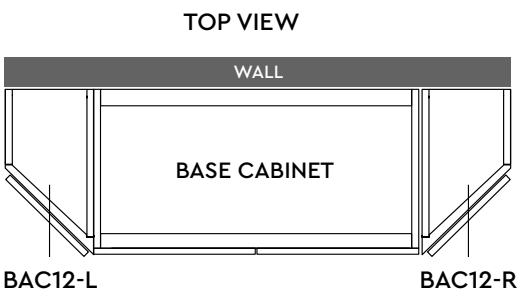

1 Door, 1 Adjustable end shelves
Specify L/R Hinge at the time of order

B. Base end shelf

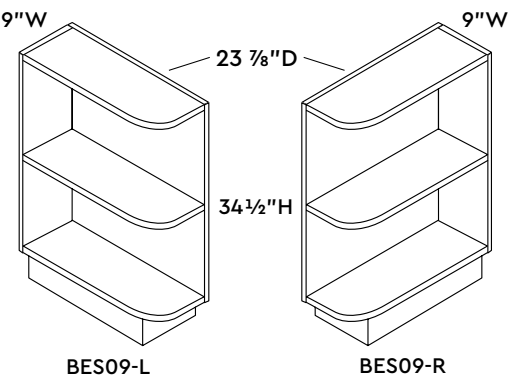

Item #	Mods
BES09	  

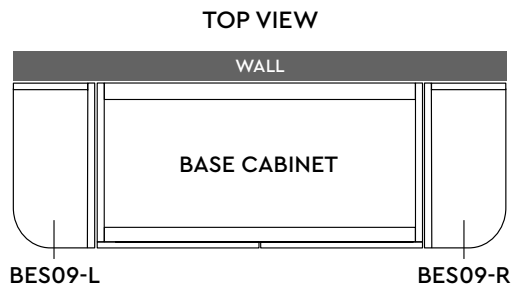

Specify L/R at the time of order
Painted matching door finish

SPECIALTY BASE CABINETS

A. Base spice rack

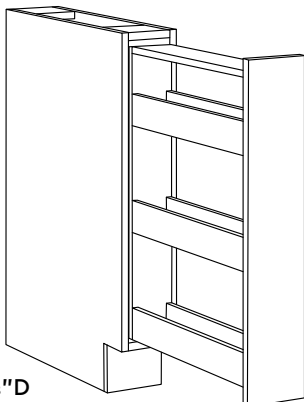

34 1/2"H

23 7/8"D

Item #	Mods
BSR06	
BSR09	
BSR12	

6" – One piece slab, 9 & 12" – Matching door, Side mount full extension drawer track (not soft closing), Includes cabinet and spice rack insert

B. Base wine rack

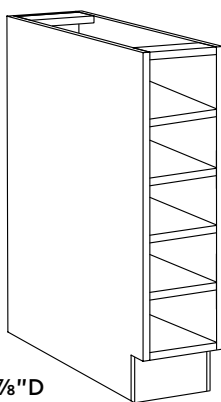

34 1/2"H

23 7/8"D

Item #	Mods
BWR06	

Painted matching door finish

C. Base microwave cabinet

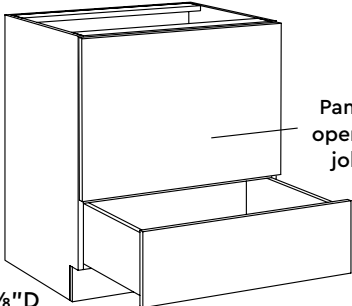

34 1/2"H

23 7/8"D

11 7/8"H

Panel; cut opening on job site

Item #	Mods
BMC30	

Designed for microwaves with trim kits.

D. Base oven cabinet

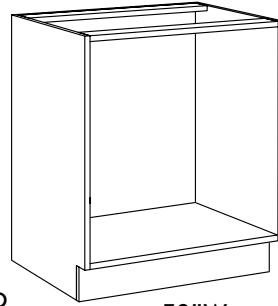

34 1/2"H

23 7/8"D

30"W

Item #	Mods
BOC30	

SPECIALTY BASE CABINETS

E. Base trash can cabinet



34 1/2"H

23 7/8"D

Item #	Mods
BTC15	

1 Drawer, 1 Door, 1 Waste bin, Soft close glides,
Available assembled

F. Base trash can cabinet



34 1/2"H

23 7/8"D

Item #	Mods
BTC18	
BTC21	

1 Drawer, 1 Door, 2 Waste bins, Soft close glides,
Available assembled

G. Full height base trash can cabinet

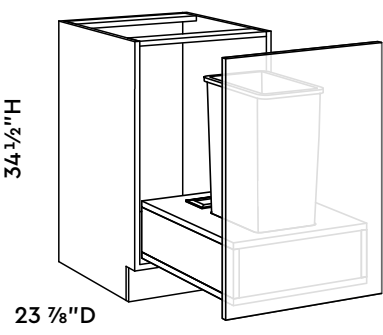

34 1/2"H

23 7/8"D

Item #	Mods
BTC18FH	
BTC21FH	

1 Door, 1 Waste bins, Soft close glides,
Available assembled

TALL CABINETS

A. Single door pantry cabinet

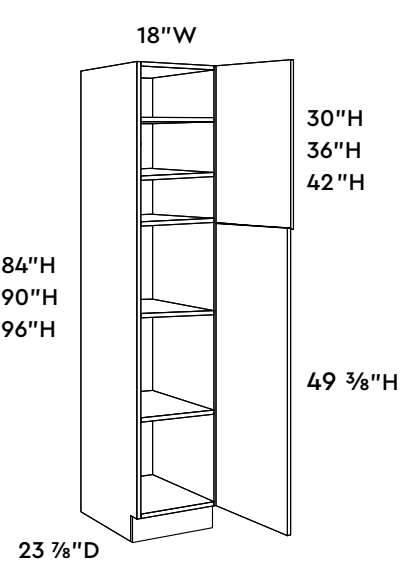

Item #	Mods
P188424	
P189024	
P189624	

2 Doors, 4 Adjustable shelves
5 Adjustable shelves for 96
Specify L/R Hinge at the time of order

B. Double door pantry cabinet

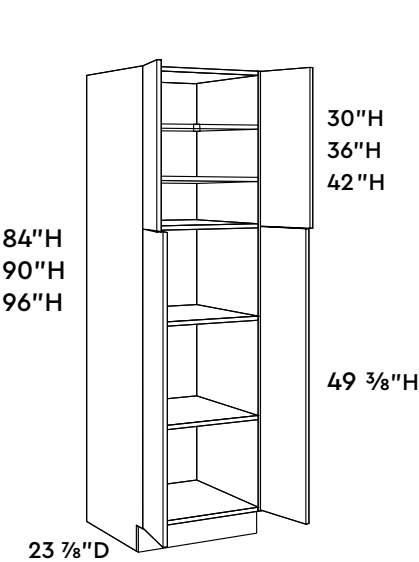

Item #	Mods
P248424	
P249024	
P249624	
P308424	
P309024	
P309624	

4 Doors, 4 Adjustable shelves
5 Adjustable shelves for 96

OVEN CABINETS

A. Oven cabinet

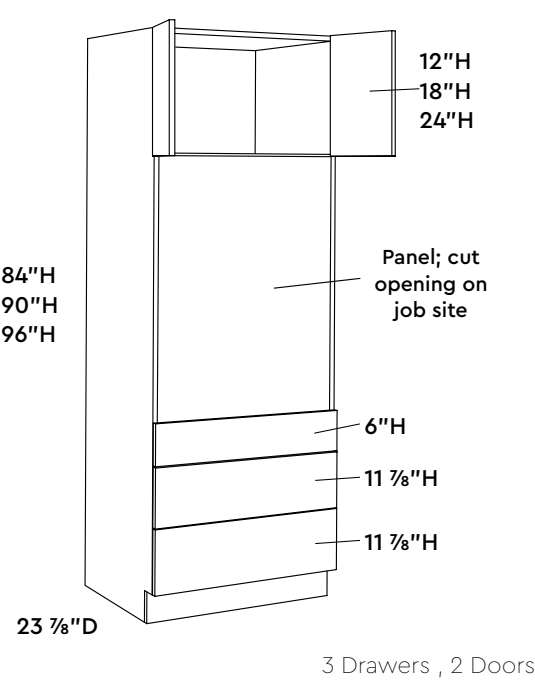

Item #	Mods
OC308424	
OC309024	
OC309624	

B. Double oven cabinet

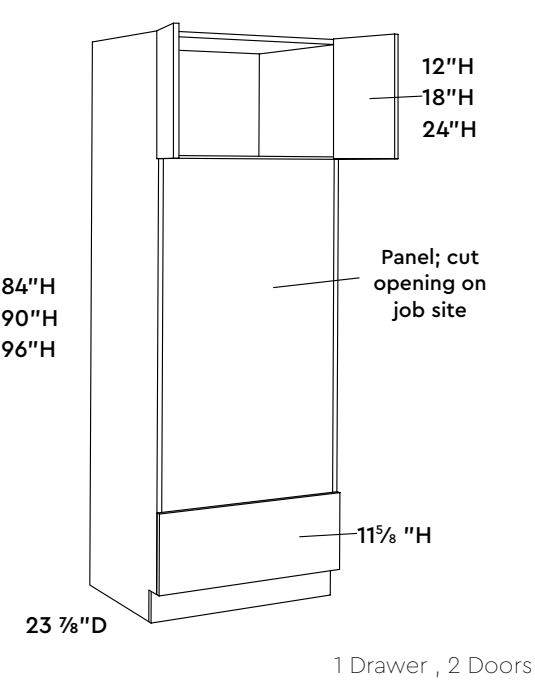

Item #	Mods
DOC308424	
DOC309024	
DOC309624	

VANITY CABINETS

A. Vanity sink base cabinet

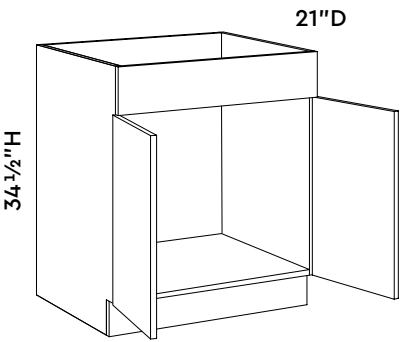

1 False Drawer, 2 Doors

Item #	Mods
V2421	
V3021	
V3621	

B. Vanity drawer base cabinet

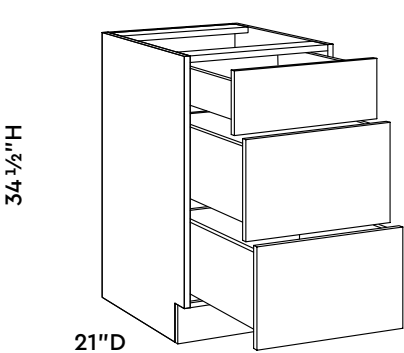

3 Drawers

Item #	Mods
VDB12	
VDB15	
VDB18	

C. Single full door double drawer vanity cabinet

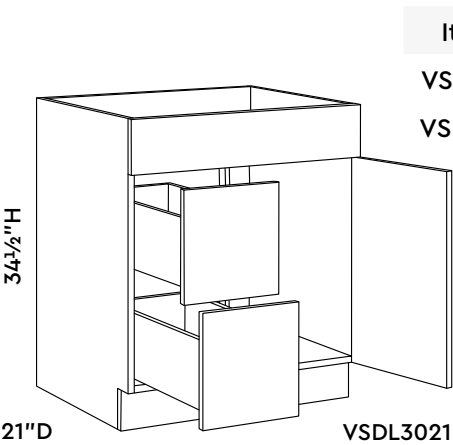

VSDL3021

Item #	Mods
VSDL3021	
VSDR3021	

D. Double door drawer vanity cabinet

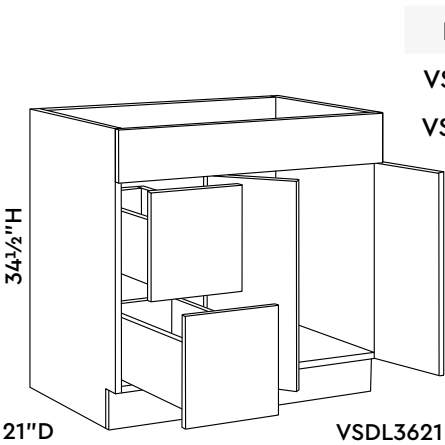

VSDL3621

Item #	Mods
VSDL3621	
VSDR3621	

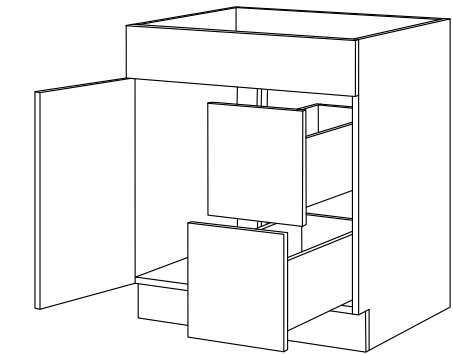

VSDR3021

1 False Drawer, 1 Door, 2 Drawers

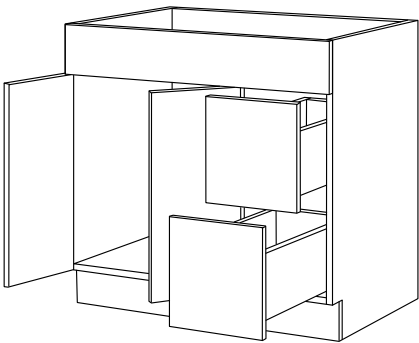





VSDR3621

1 False Drawer, 2 Door, 2 Drawers

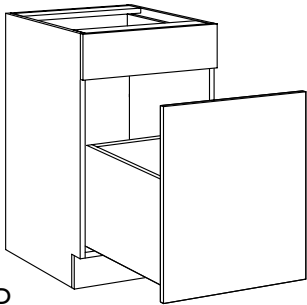
DESK CABINETS

A. Base file drawer cabinet



Item #	Mods
BFD18	  

2 Drawers

B. Knee drawer

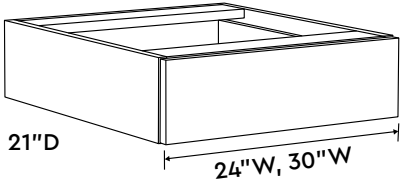

Item #
KD24
KD30

Soft close

C. Desk support

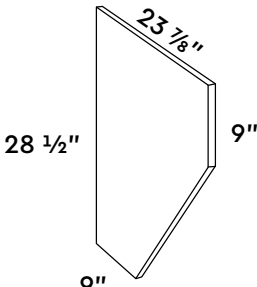

Item #
VDS

GLASS DOORS

A. Wall glass doors

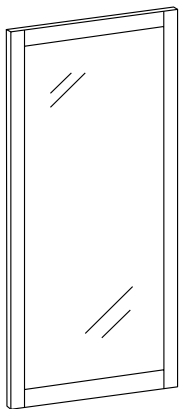

Clear glass only

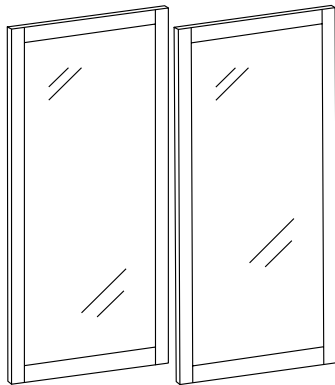

Clear glass only

Width 24", use (2) **WGD12##**
Width 30", use (2) **WGD15##**
Width 36", use (2) **WGD18##**

Item #
WGD1215
WGD1230
WGD1236
WGD1242
WGD1515
WGD1530
WGD1536
WGD1542
WGD1815
WGD1830
WGD1836
WGD1842

B. Corner Wall Glass door

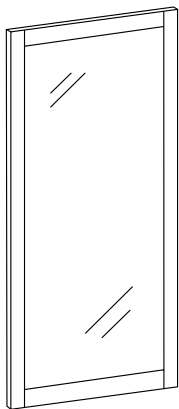

Clear glass only

Item #
CWGD2415
CWGD2430
CWGD2436
CWGD2442

WALL ACCESSORIES

A. Stem glass holder

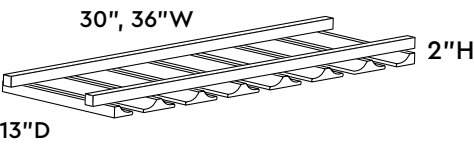

- Item #
- SGH30
 - SGH36

B. Floating shelf

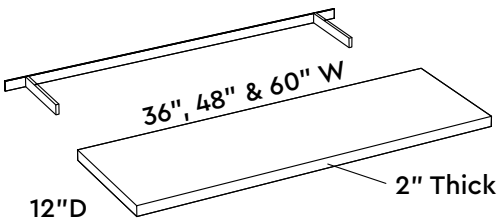

- Item #
- FS36
 - FS48
 - FS60

BASE ACCESSORIES

A. Natural Wood Lazy Susan Tray

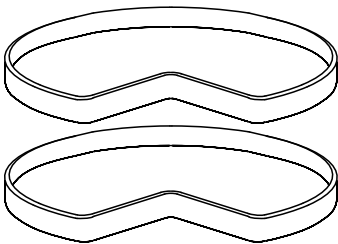

Wood
2 Trays; top and bottom

- Item #
- XN-LSTRAY33
 - XN-LSTRAY36

B. Metal Lazy Susan Tray

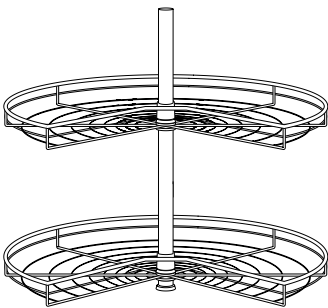

Metal

- Item #
- XM-LSTRAY33
 - XM-LSTRAY36

VALANCE

A. Valance

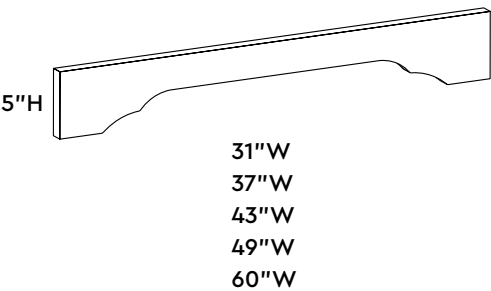

- Item #
- V31D
 - V37D
 - V43D
 - V49D
 - V60D

B. Arched valance

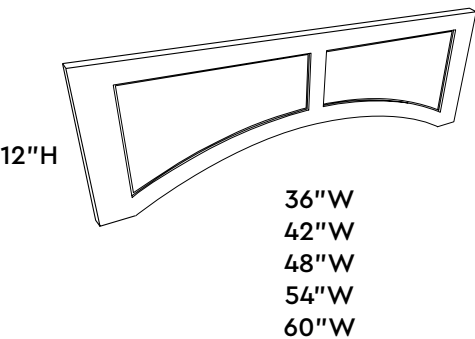

- Item #
- AV3612
 - AV4212
 - AV4812
 - AV5412
 - AV6012

FILLERS

A. Base filler

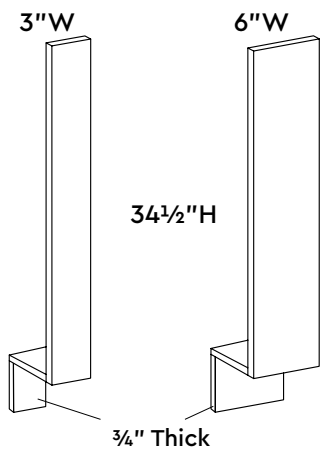

- Item #
- BF3
 - BF6

B. Fillers

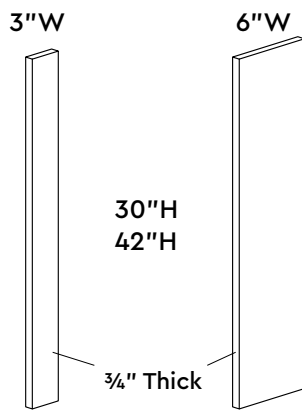

- Item #
- F330
 - F630
 - F342
 - F642

C. Tall fillers

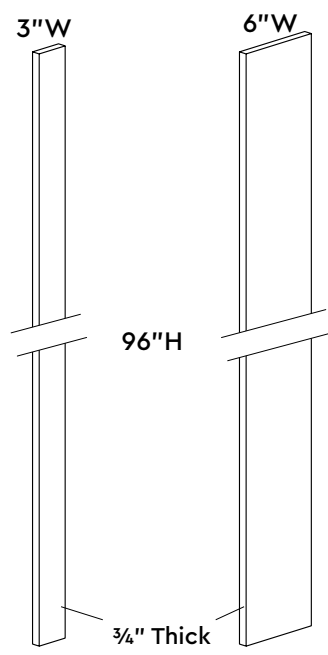

- Item #
- F396
 - F696

D. Overlay fillers

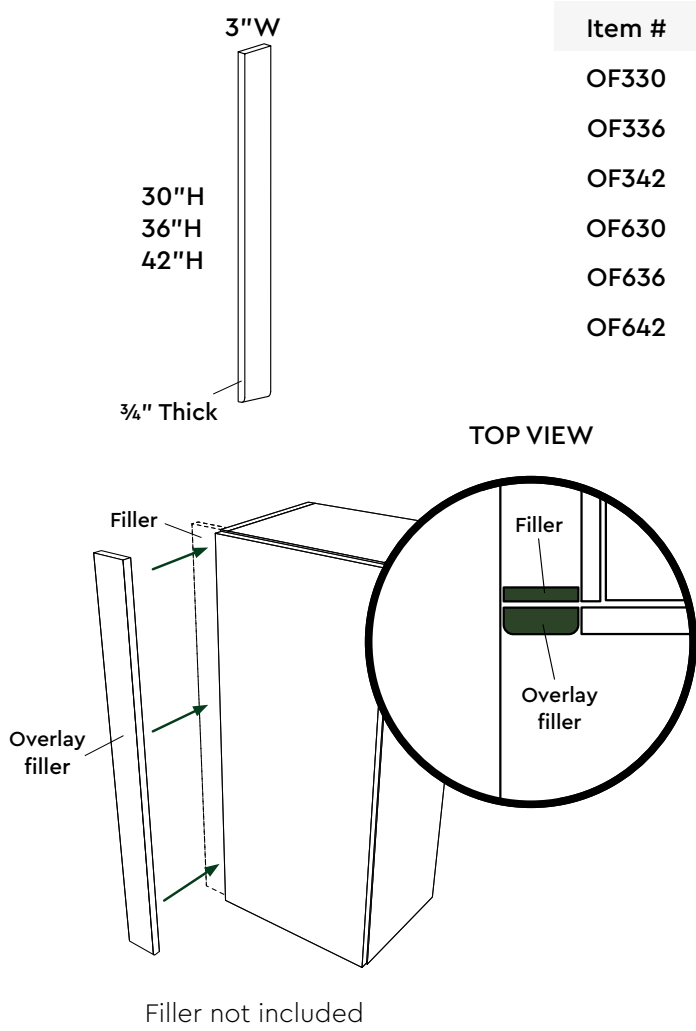

- Item #
- OF330
 - OF336
 - OF342
 - OF630
 - OF636
 - OF642

FINISHED END PANELS

A. Back panel

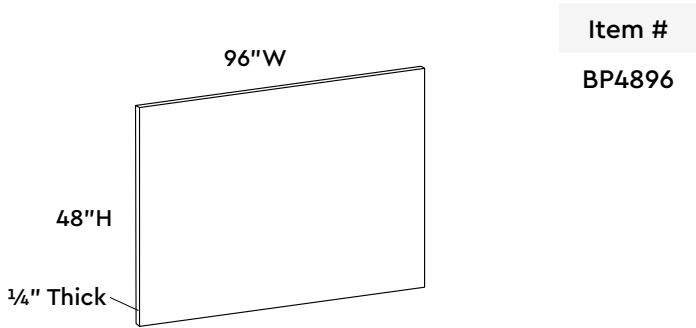

B. Dish washer panel

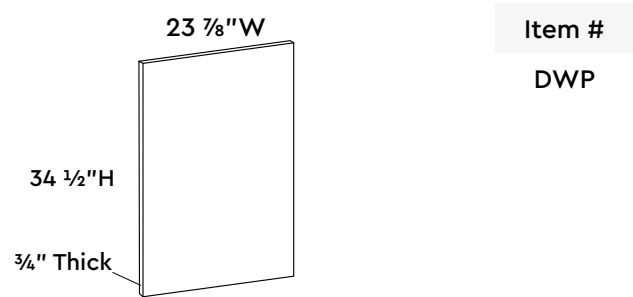

Both 34 1/2" length sides are edge-banded

C. Refrigerator panel

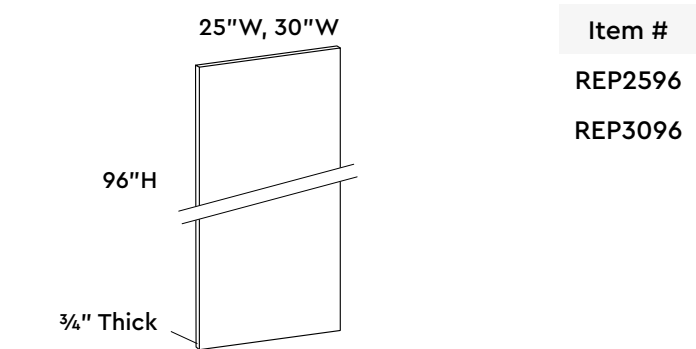

Both 96" length sides are edge-banded

D. Base end panel

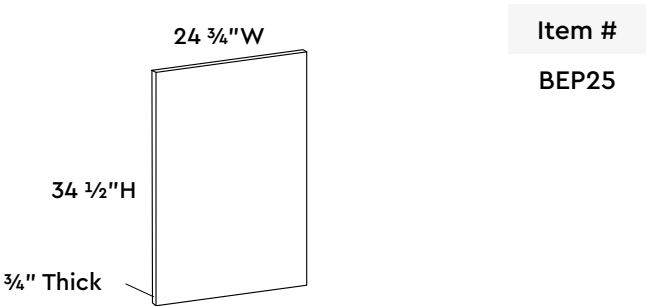

Both 34 1/2" length sides are edge-banded

E. Wall end panel

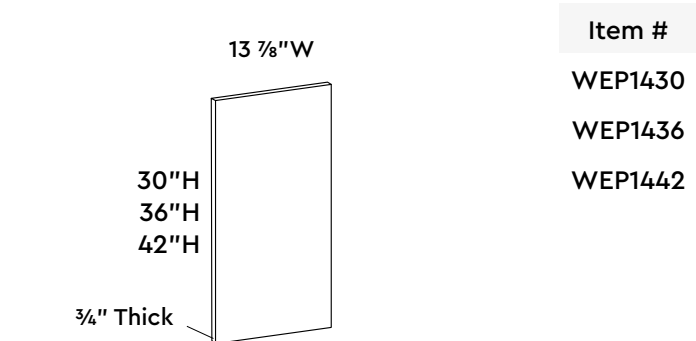

All sides are edge-banded

F. Toe kick

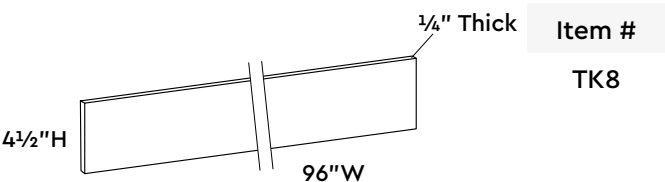

FINISHED END PANELS

G. Base integrated panel

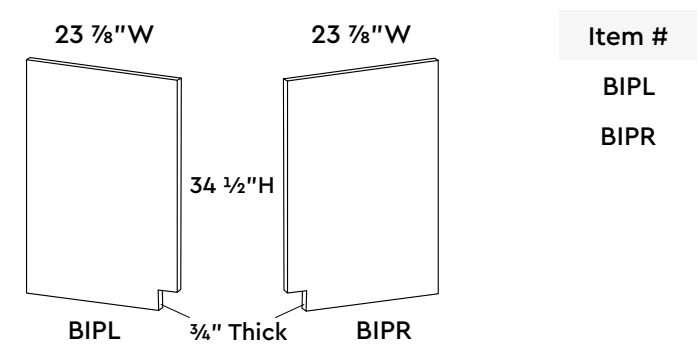

Compatible with B, 2DB, 3DB only, Not sink/BMC
Exterior edge banding matching door finish,
White Interior
Not required for Arctic Colors

H. Wall integrated panel

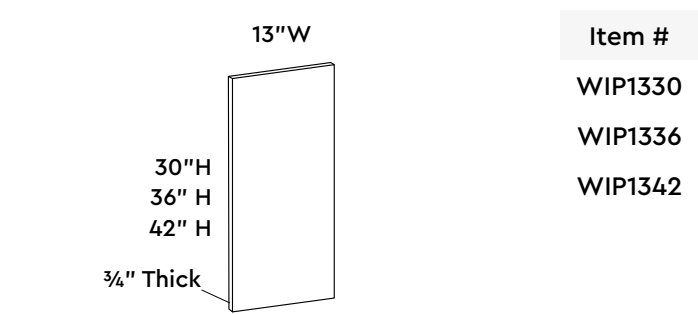

Not compatible with Corner Walls
Exterior edge banding matching door finish,
White Interior
Not required for Arctic Colors

DECORATION DOORS

A. Wall end decoration door

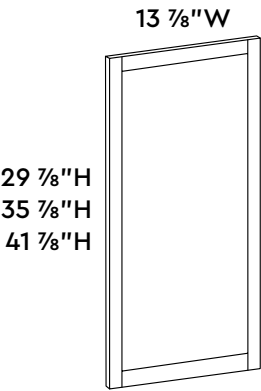

Item #
WED1430
WED1436
WED1442

B. Base decoration door

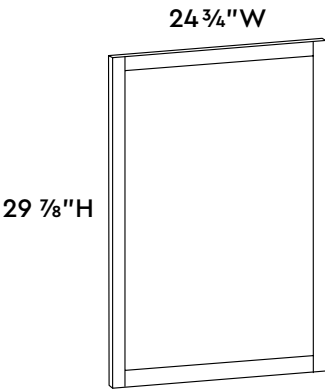

Item #
BED2530

C. Pantry end decoration door

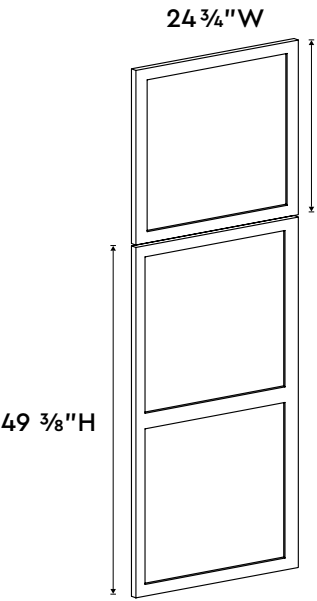

Item #
PED2584
PED2590
PED2596

MOLDINGS

A. Crown molding

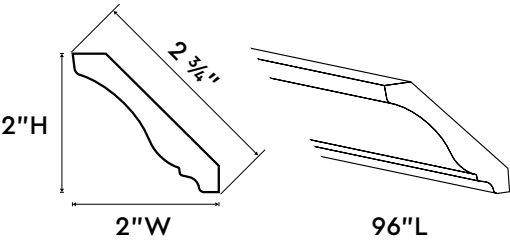

Item #
CM8

B. Crown molding 4"

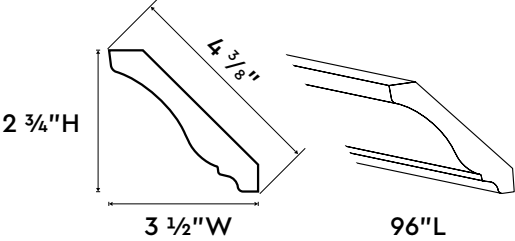

Item #
BCM8

C. Crown molding cove

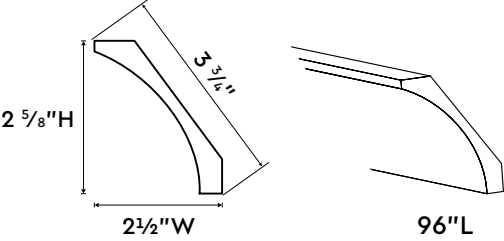

Item #
CMC8

D. Crown molding - Flat

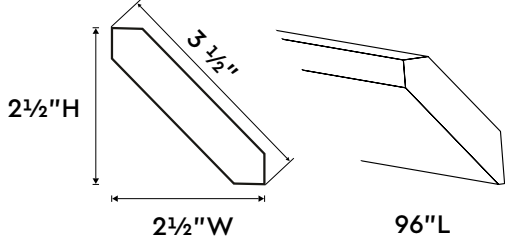

Item #
FCM8

E. Outside corner molding

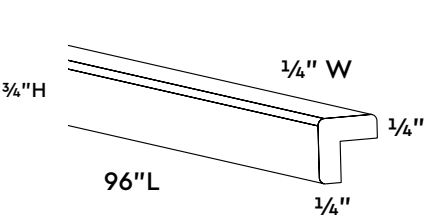

Item #
OCM8

F. Scribe molding

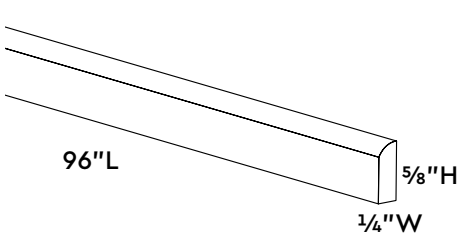

Item #
SM8

G. Base shoe molding

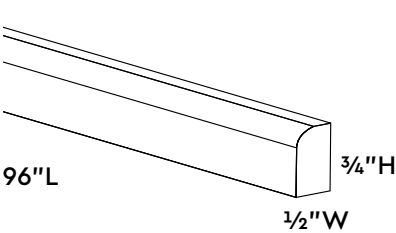

Item #
BSM8

H. Batten molding

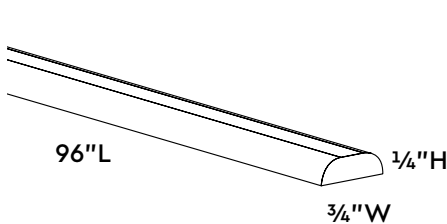

Item #
BM8

MOLDINGS

I. Baseboard molding

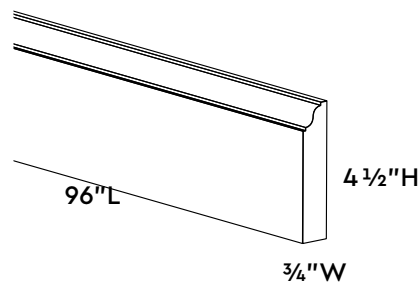

Item #
BBM8

J. Light rail molding

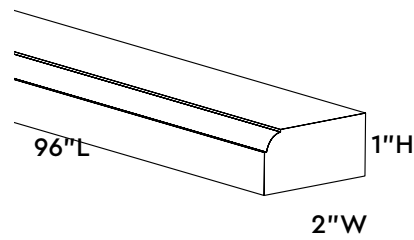

Item #
LRM8-G

K. Light rail molding

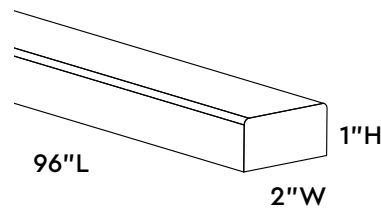

Item #
LRM8-S

L. Soffit molding

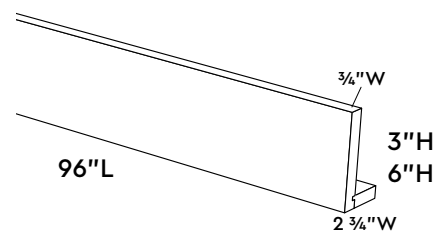

Item #
SFM3
SFM6

FRONT VIEW

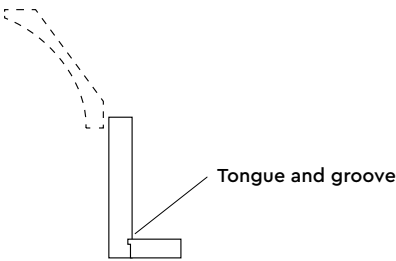

RANGE HOOD

A. Range Hood

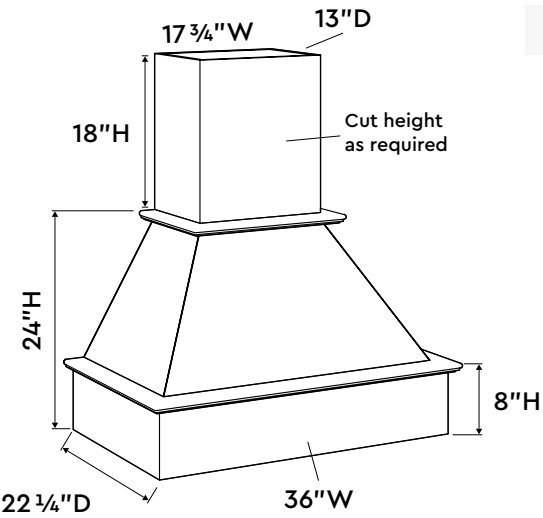

Item #
RHOOD

Inside opening 34 1/2 W x 20 1/2 D

B. Custom Range Hood

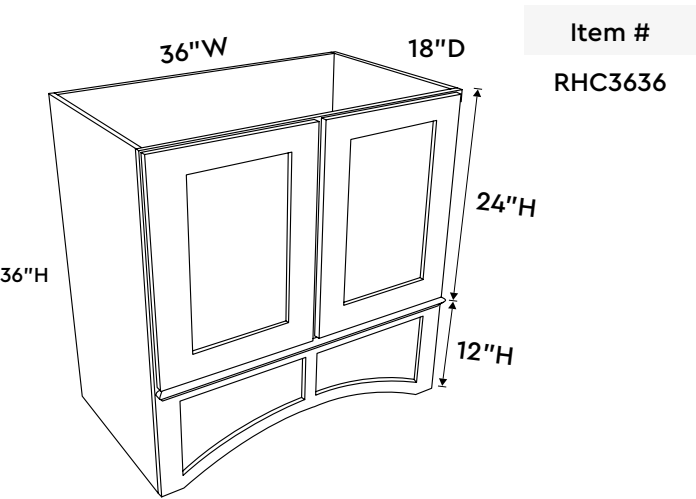

Item #
RHC3636

Custom: Available assembled only
Extended lead time may apply

C. Custom Range Hood

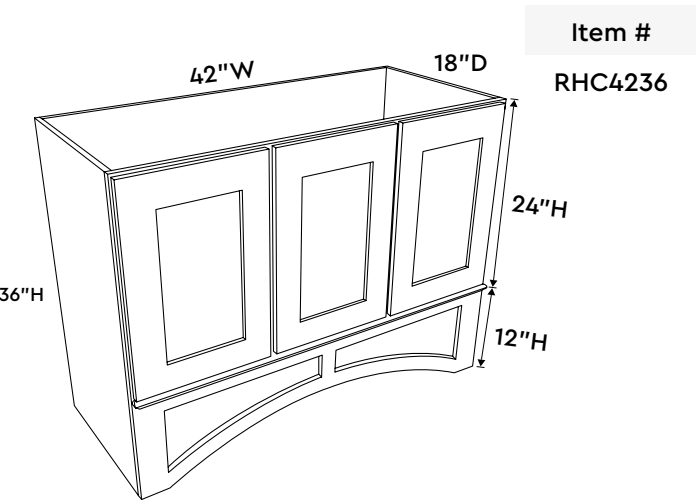

Item #
RHC4236

Custom: Available assembled only
Extended lead time may apply

D. Custom Range Hood

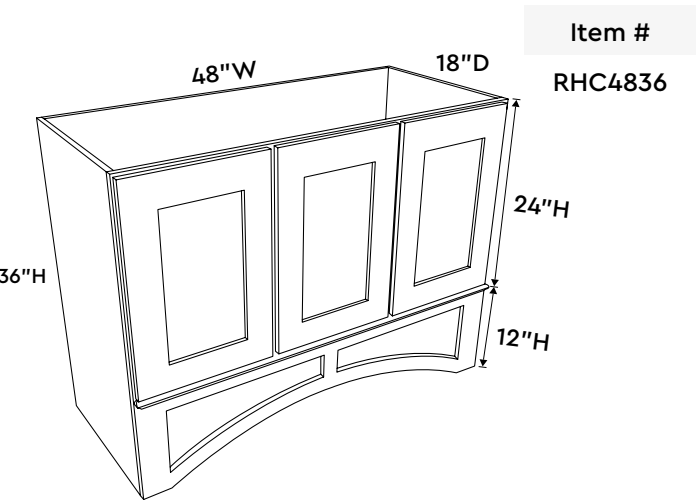

Item #
RHC4836

Custom: Available assembled only
Extended lead time may apply

POST

A. Post

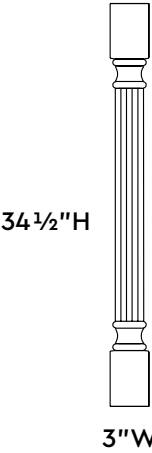

Item #
TP3-2

B. Post

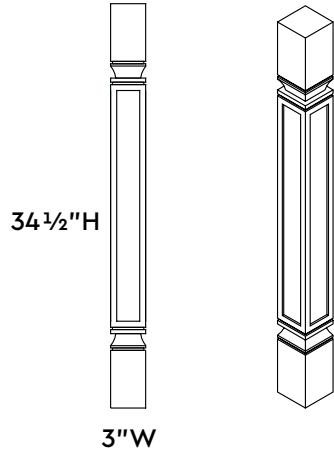

Item #
PS-3

UPGRADES

A. Taller trash can kit

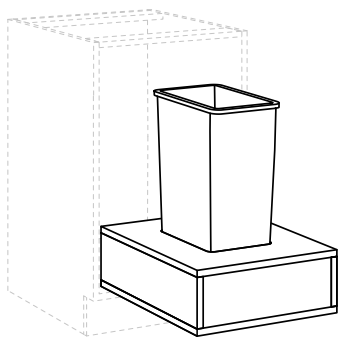

1 Waste bin, Soft close glides

Item #
TC18-1WT
TC21-1WT

B. Trash can kit

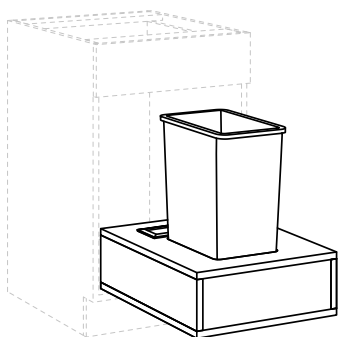

1 Waste bin, Soft close glides

Item #
TC15-1W

C. Trash can kit

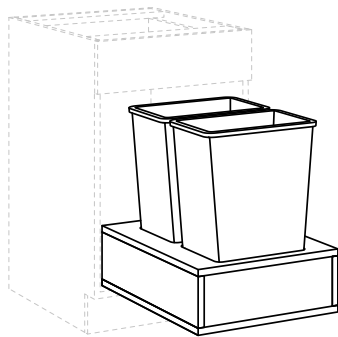

2 Waste bins, Soft close glides

Item #
TC18-2W
TC21-2W

E. Roll out tray

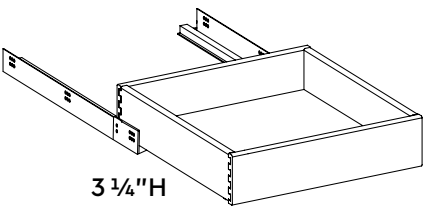

Drawer with soft close glides

Item #
ROT15W
ROT18W
ROT21W
ROT24W
ROT27W
ROT30W
ROT33W
ROT36W

PRODUCT CARE

A. Touch-up kit

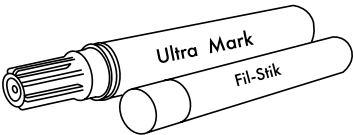

1 Ultra Mark, 1 Fil-Stick, by Mohawk
Finishing Products

Item #
TUK

B. Disassembly Key

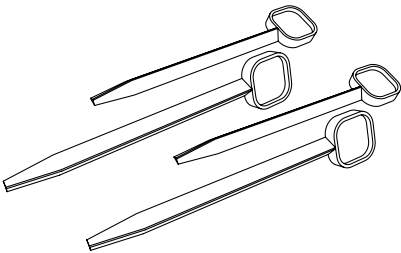

Disassembly cabinet key
4 pieces

Item #
TSK-4

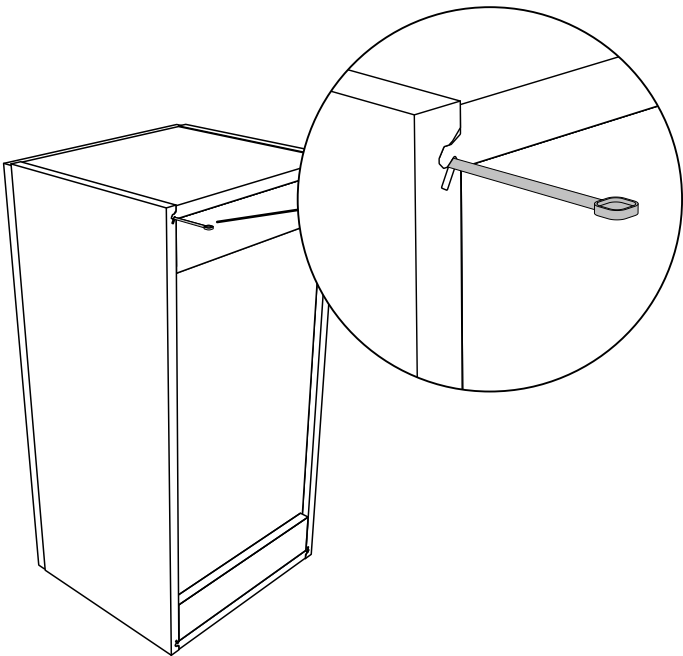

SAMPLES

A. Sample door

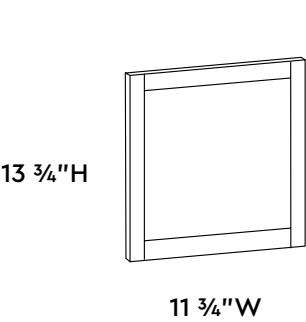

Item #
SD

B. Sample door set

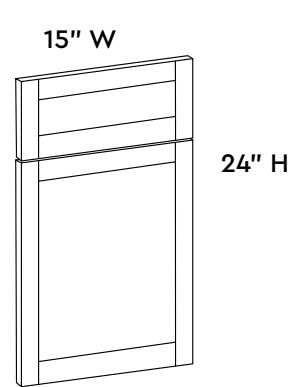

Item #
SDL

C. Sample mini base

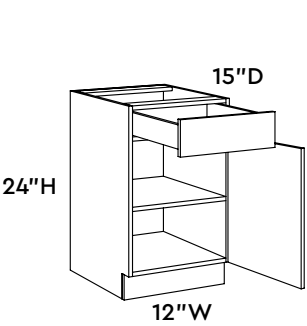

Item #
SMB12

Only available with Legacy Nimbus Door
and White eRTA cabinet

D. Display Center

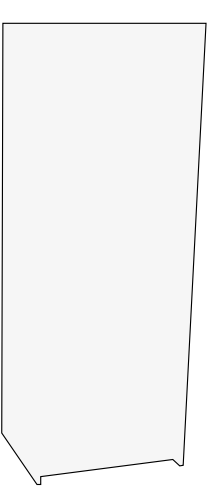

Item #
COMING SOON

NOTES

LIMITED WARRANTY

Warranty Coverage

PF Sales, LLC DBA Makellos Cabinetry ("Makellos") is pleased to provide the following limited warranty on all cabinets imported to and assembled and sold in the United States and Canada by Makellos. This warranty does not cover cabinets sold or shipped outside of the United States and Canada. This limited warranty is subject to all limitations, exclusions, disclaimers and procedures set forth herein. Makellos warrants to the original purchasing consumer that all cabinets purchased from Makellos will be free from all unnatural defects in material and workmanship under normal residential use for 5 years from the date of the original purchase or as long as the original purchasing consumer owns the home in which such cabinets are installed, whichever is less. This warranty is nontransferable to subsequent owners of the home.

Exclusions

This warranty supersedes any and all previous warranties by Makellos and constitutes the exclusive remedy against Makellos for all defects, damages and workmanship. There are no implied warranties extending beyond the terms of this warranty. Makellos shall not be liable for any indirect, special, punitive, incidental or consequential costs, expenses or damages. This warranty gives you specific legal rights, and you may also have other rights, which vary from state to state. It is possible that one or more of the limitations and exclusions in this warranty may not apply to you.

Limitations

This warranty shall become void if the cabinets, cabinetwork, drawer slides or hinges are modified from their original form, improperly installed or damaged prior to or during the installation, or used in any way other than for residential purposes. This warranty covers only parts and materials of the cabinets as supplied by Makellos. This warranty does not cover any products used or installed in connection with cabinets, such as gas or electric appliances, counter tops, or plumbing fixtures. This warranty does not apply to products installed in locations that do not maintain year-round environmental controls. This warranty does not apply to damage caused by transportation, storage, excess dirt, chemicals, exposure to moisture, humidity or excessive heat or cold, nor does it cover defects arising from normal wear and tear, misuse, neglect, accidents, alterations, improper use or failure to ensure proper maintenance, house settling, or acts of God. No installer, retailer, distributor, agent or employee of Makellos has the authority to alter the obligations or limitations in this warranty.

Disclaimers

The following is a brief recap of some of the characteristics of the wood and finishes on the cabinets you are about to purchase. Please read them carefully. If some of these characteristics concern you, please choose something else. We bring these characteristics to your attention so you are aware that Makellos will not be held responsible for these variations in any cabinetry sold or supplied. It is important to note that wood products claimed as defective are most often the result of atmospheric conditions such as excess moisture and humidity. Makellos strongly recommends testing the intended location of the products for such conditions prior to installation.

WOOD AND COLOR VARIATIONS: Wood is a product of nature, and since no two trees are exactly alike, cabinets may vary in color, texture and grain. Naturally occurring characteristics such as variations in color, grain, mineral streaks, pinholes and knots are not considered defects. Color variations are a natural occurrence due to species, age, character of cabinets, and exposure to UV light and sunlight. For these reasons, new and/or replacement cabinets may not exactly match display samples and/or existing cabinets, but is not considered a defect.

WOOD DOORS: Wood, by nature, will undergo expansion and contraction year after year as it compensates and adjusts to ever-changing humidity and temperature. It is very common for center panels on doors to shrink, expand or move during these transitions. Typically, the panel will return to its normal position within a year once it has adjusted to seasonal changes. It is for these reasons that it is very common for doors to warp during these periods. Doors that are warped up to 1/4" are not considered defective. Please Note: It is advisable to check if the door was properly installed, since doors that appear warped are very often the result of improper installation.

PAINTED FINISHES: Birch is a non-porous, smooth grained wood, and wood undergoes periods of expansion and contraction while it adjusts to atmospheric conditions. As such, finish stress lines may become visible on painted cabinets, especially at the joints. Any such occurrence is not considered a defect.

Warranty Performance

If a defect does occur within the terms and conditions of this warranty, the defective part will be repaired or replaced at the sole discretion of Makellos. Makellos will not provide or pay for the cost of removal of any defective product, transportation of any defective product, repair or replacement of any Product, or the installation of repaired or replaced products. Makellos will not be responsible for any shipping damages to the defective, replaced or repaired product. If a defective item has been discontinued or is not available at the time, Makellos reserves the right to replace the item with the most similar item available in Makellos' inventory. Makellos cannot guarantee that the finish of any replacement will exactly match the finish and appearance of the defective item due to the natural aging process of the wood and finishes of the cabinets. Makellos may require, at its sole discretion, that the customer submit a clear photo, or that a company representative view the item being claimed before honoring this warranty.

Claims

To submit a claim covered under this warranty, the original proof of purchase or a copy must be provided. Please email all documents to rma@makellos.com.

Note

Please do not send back any items to Makellos prior to receiving proper authorization from customer service. Makellos takes no responsibility for any items sent back without proper return authorization.

TERMS AND CONDITIONS

Quality Standards

Please review Makellos standards for specifics on the coverage extended in our five year warranty. As mentioned in our warranty, Makellos retains the right to modify said standard sheet at any time. Generally, our RMA department will request a photographic proof of defects, or in some cases, request item be sent back for examination. However, Makellos reserves the right to send a representative down to view damages and determine liability. Method of proof is determined solely by the discretion of Makellos' RMA department. All items sent for return are subject to evaluation by our RMA department. Items deemed not to be defective will not be eligible for credit or coverage under our warranty. Keep in mind that credits for returns are not given until items arrive in Makellos' facility or adequate photographic proof is supplied. Dealer will be charged for replacement items and credit will only be given at such time that proof is received and deemed acceptable.

Center Panel Shrinkage

Because expansion and shrinkage is expected with all natural wood products, defects cannot be determined until six months of settling time have passed. Once six months have passed since the installation, excessive shrinkage should be discussed with our RMA department. Wood by nature, may experience some expansion or shrinkage over time. Therefore, center panels that experience shrinkage up to 1/8" are not considered defective. Cabinetry should be kept in climate controlled areas only. As clearly stated in our warranty, products exposed to extreme moisture, excessive heat or cold, are not covered by Makellos. For natural shrinkage that exceeds 1/8", please contact Makellos for a touch up kit.

Warped Doors

Variances and a minimal amount of warping can be expected with natural wood products. Doors warped up to 1/4" are not considered defective. Panels and moldings are not considered defective unless warping exceeds 2". On many occasions, what appears as a door defect may easily be resolved by adjusting the hinges. Please examine and adjust your hinges before claiming Makellos' limited warranty.

Hairline Cracks

Wood, by nature, may experience a standard amount of expansion and shrinkage; as such, hairline cracks in painted doors may occur. Hairline cracks through which wood is visible, are not considered defects covered by Makellos' three year warranty. Makellos will not be held accountable for color variances due to sunlight, UV light, or atmospheric conditions. For variances that fall outside of the above criteria, Makellos' RMA department will review all concerns and determine if said variance is considered a defect.

Grains and Color Variance

All Cabinetry should be inspected for cosmetic defects before being drilled for hardware. Once holes are made, Makellos will no longer be held liable for any color variances on new cabinets. Wood products feature natural grains of varying shades. These characteristics are determined by nature and are in no way considered a defect in the product. Glaze is an applied finish which may feature slight variances in shading, evenness or thickness. These are common features of glaze and are not considered a defect. Due to natural differences found in wood, cabinets may vary in color, texture and grain. Varied shading in cabinetry stains are expected and are not considered a defect. Makellos will not be held accountable for color variances due to sunlight, UV light, or atmospheric conditions. For variances that fall outside of the above criteria, Makellos' RMA department will review all concerns and determine if said variance is considered a defect.

KD Cabinetry

KD cabinetry is not assembled by Makellos, and as such, are not covered by Makellos warranty and construction related damages.

Pick Ups

Cabinetry picked up from Makellos' warehouse is shipped via carrier of the customer's discretion. Since Makellos cannot guarantee the shipment method, items picked up from Makellos are not covered for damages under the five year warranty. As such, we recommend customers inspect all items before leaving our warehouse.

Accessories

For accessories that have color variances, size differences, or any other concern, please send requested pictures of merchandise to Makellos' RMA department.

Returns

Makellos is committed to providing quality products and excellent service, and will work with customers until satisfied. However, once a cabinet leaves our facility, Makellos does not accept returns unless they fall under the provisions made in our warranty.

Please note; once an RMA has been approved for a replacement, the request for a new item is fulfilled as a standard order. Replacement items therefore have the ETAs of a regular order.



Makellos Cabinetry

7400 State Road, Philadelphia, PA 19136

For dealer information,
Please contact info@makellos.com
or www.makellos.com

©2024 Makellos Cabinetry. All Rights Reserved.